

Installation Guide

Single Handle Tall Lavatory Faucet 2010.205L.100

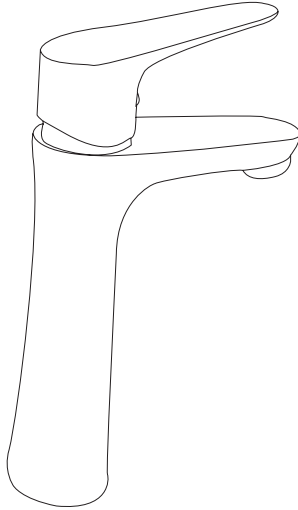

Thank You For Choosing Valley Acrylic

All the information in this guide is based upon the latest product information available at the time of publication. We reserve the right to make changes in product characteristics, packaging, or availability at any time without notice.

Please take a few minutes to review this guide. If you encounter any installation or performance problems, please call 1-877-398-tubs (8827) from within the USA and Canada.

GENERAL REQUIREMENTS

IMPORTANT: For easy installation, please read all of the instructions completely before beginning. Before installing this product, make sure that water line trash is cleared to avoid blockage.

WARNING: Assembly by a professional plumber is required.

YOU MAY NEED:

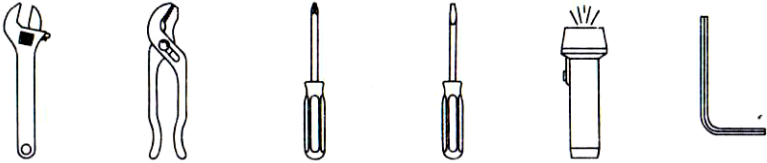

MAINTENANCE

1. Replacement parts may be available at the store where you purchased your faucet.
2. Always turn off water and relieve pressure before working on your faucet.

CLEANING INSTRUCTIONS

1. To keep the faucet clean you should clean the faucet frequently.
2. Clean the faucet with clear water then dry with soft cotton cloths.
3. Do not use any abrasive cleansers, cloths, or paper towel.
4. Do not use any acidic or abrasive detergent.

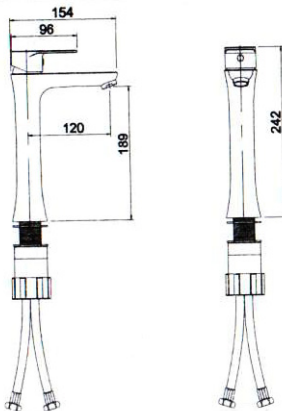

INSTALLATION PROCEDURES

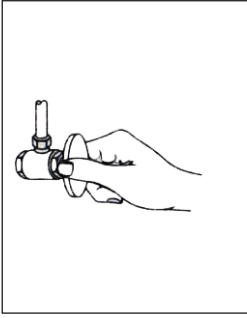

STEP 1: Clean all debris from valve outlets. Turn off water supply valves. This is usually found near the water heater. If you are replacing an existing faucet, remove the faucet from the sink and clean the sink surface thoroughly

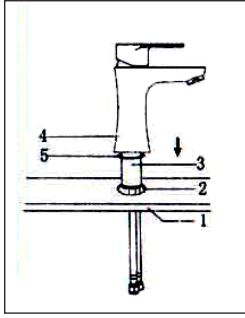

STEP 2: Drill a $\varnothing 1\text{-}3/8$ tp 1-1/2 hole(2) in sink(1). Install the shank(3) into the faucet body(4) and screw them firmly. then put O-ring(5) into base groove and insert them through the hole(2)

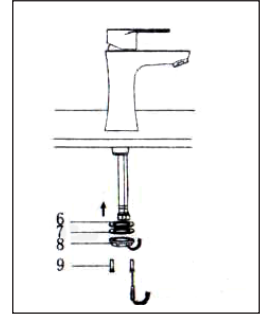

STEP 3: Adjust the faucet to the right position and put on the rubber gasket(7) and lock nut(9), secure them tightly.

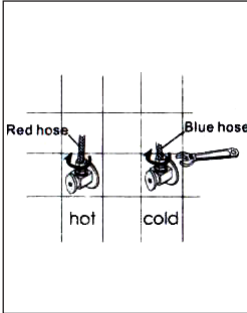

STEP 4: Connect the flexible hoses to the water-supply valve (Hot water left, Cold water right)

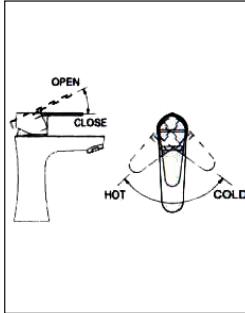

STEP 5: Pull the handle upward in horizontal line to turn on the faucet, downward in horizontal line to turn off. Face the spout, move the handle left to control hotwater and right to control cold water

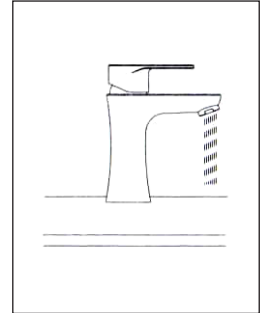

STEP 6: Check every joint to make sure it has been connected properly. Open the pop-up then turn on the water to check for leakage.

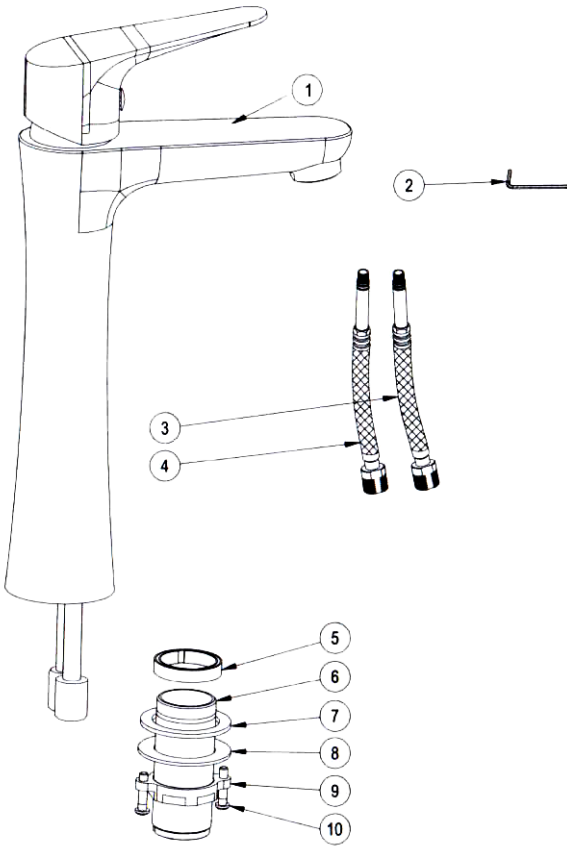

- 10 Screw
- 9 Lock Nut
- 8 Metal Gasket
- 7 Rubber Gasket
- 6 Shank
- 5 Nut
- 4 Hot Hose
- 3 Cold Hose
- 2 Allen Key
- 1 Basin Mixer

TROUBLESHOOTING

If you have followed the instructions carefully and your faucet still does not work properly, take these corrective steps.

Problem	Cause	Action
Leaks underneath handle	Cartridge has come loose	Tighten the cartridge
Aerator leaks or has an inconsistent water flow pattern	Aerator is dirty, worn out, or misfitted.	Unscrew the aerator to clean or replace washer, or replace the aerator
Water will not shut off completely	Dirty or work out washer in cartridge	Remove handle and cartridge to check if the water is damaged permanently or dirty. Re-install cartridge.