







DESCRIPTION:

- Bathtub drain with overflow.
- Complies with CSA & IAPMO standards.

BATHTUB DRAIN OPTIONS:

- | | | | |
|---|---------------------------------|---|----------------------------|
|  | A38807PCP
(Chrome) |  | A38807BLK
(Matte Black) |
|  | A38807PBN
(Brushed Nickel) |  | A38807GLD
(Gold) |
|  | A38807RB
(Oil Rubbed Bronze) | | |

SHIPPING INFORMATION:

- | | |
|--------------------------|---------------------------------|
| • Length: 25.25" / 641mm | • Net Weight: 1 kg / 2 lbs. |
| • Width: 3.75" / 95mm | • Gross Weight: 1.5 kg / 3 lbs. |
| • Height: 3.25" / 83mm | |

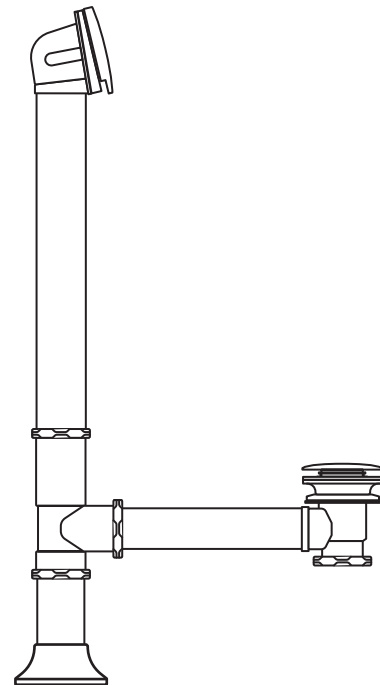

Measurements may vary ±5mm
- Diagram NOT to scale -

IC **US**
Complies With :
CSA B24S1 (2004)
CSA B45.5 (2002)
ANSI Z124.1.2 (2005)

NO.	PART NAME	QTY.
1	MAIN DECORATIVE POP-UP CAP	1
2	SEAL CLEAR GASKET	1
3	BRASS MECHANICAL ROD	1
4	MAIN UPPER DRAIN BODY	1
5	UPPER DRAIN GASKET	1
6	LOWER DRAIN GASKET	1
7	LOWER DRAIN BODY	1
8	BOTTOM CAP GASKET	1
9	BOTTOM CAP	1
10	EXTENSION PIPE	1
11	WING NUT	1
12	SEAL GASKET	1
13	ESCUTCHEON PIECE	1
14	TAIL PIECE	1
15	SEAL GASKET	1
16	WING NUT	1
17	T-BODY	1
18	SEAL GASKET	1
19	WING NUT	1
20	LONG CONNECTION PIPE	1
21	BACK OVERFLOW BODY	1
22	BACK OVERFLOW GASKET	1
23	FRONT OVERFLOW GASKET	1
24	FRONT DECORATIVE CAP	1
25	STAINLESS STEEL SCREW	1
26	SHORT CONNECTION PIPE	1

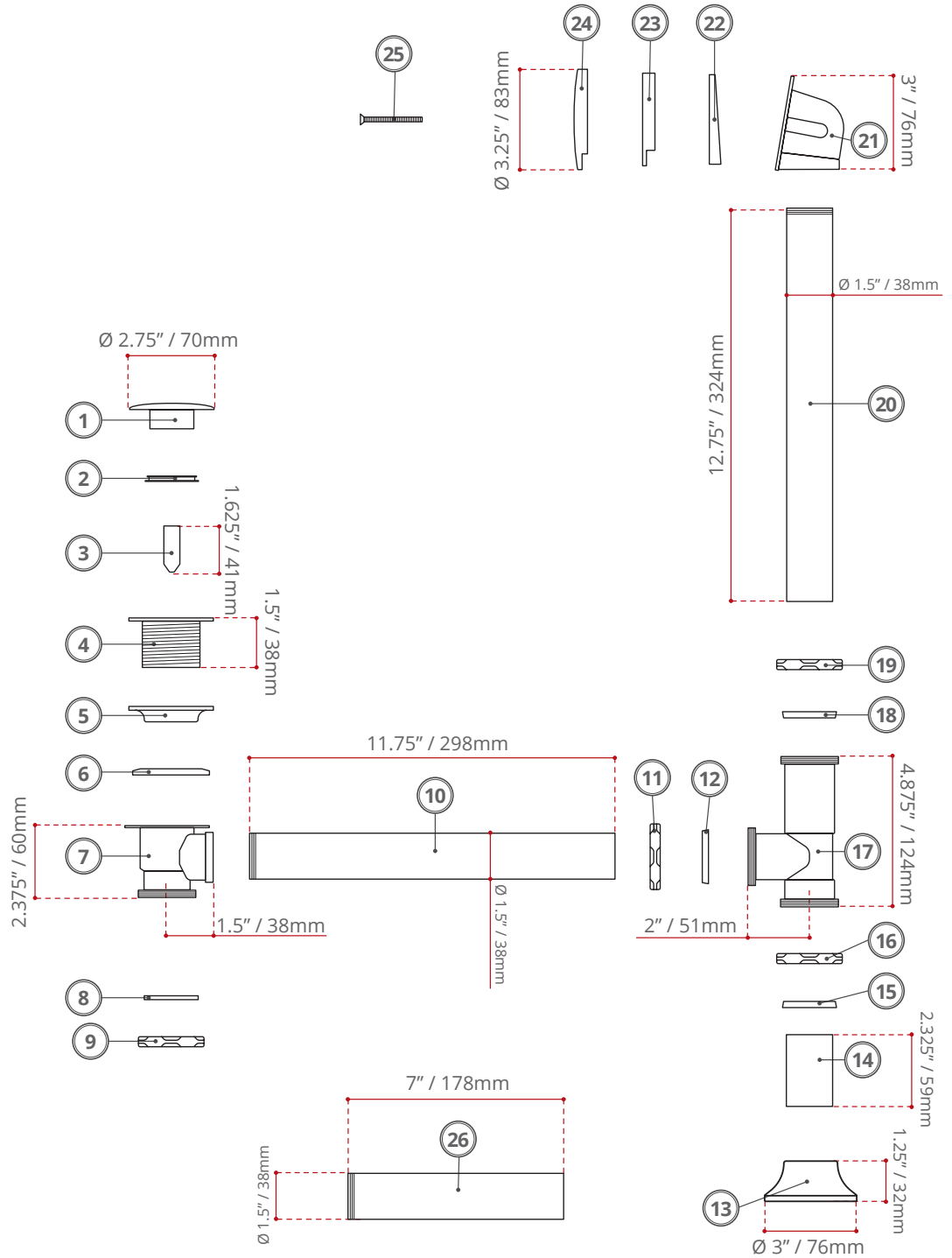

Measurements may vary ±5mm
- Diagram NOT to scale -

LC **US**
Complies With :
CSA B2451 (2004)
CSA B45.5 (2002)
ANSI Z124.1.2 (2005)