

APRON KITCHEN SINK INSTALLATION GUIDE



VALLEY⁺

...you dream it, we create it

Thank you for choosing Valley Acrylic Products. This installation manual provides general information on the installation of our products.

All the information in this guide is based upon the most recent product information available at the time of this publication. Valley Acrylic reserves the right to make changes to product characteristics, packaging, or availability at any time without notice.

Thank you for your purchase!



Please unpack and inspect all parts carefully to make sure they are complete and not damaged. If any parts are damaged or missing, please contact the authorized dealer you purchased the product through.

BEFORE YOU BEGIN

- Please read these instructions carefully before beginning your installation.
- Consult your local building codes to ensure that your installation complies with local standards.
- Remove the unit from its packaging. Before disposing, packaging and taking unit from your sales person, inspect the unit to make sure it is in good shape.
- Should inspection reveal any damage or defect in the finish, please contact the authorized dealer you purchased the product through. The warranty does not cover damages or defects in the finish once the unit has been installed. Valley's responsibility for shipping damages ceases upon delivery of the product in good order to the carrier. All complaints regarding damage due to transport must be made directly to the carrier.
- Please refer to your product's specification sheet and ensure that both your unit and build plan measure match the stated sizes.

REQUIRED TOOLS & MATERIALS

- Eye Protection (Safety glasses / goggles) strongly recommended.
- Ear protection strongly recommended.
- Cut-out template.
- Mounting clips.
- Pencil (not permanent marker)
- Tape measure.
- Jigsaw
- Ball peen hammer
- Silicone sealant
- Wrench



BEFORE INSTALLING THIS SINK, VERIFY THE SINK MEASUREMENT.

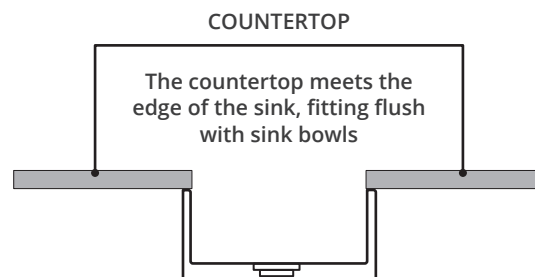
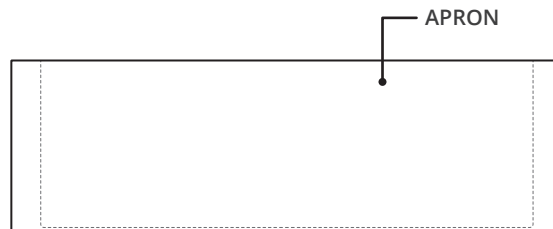
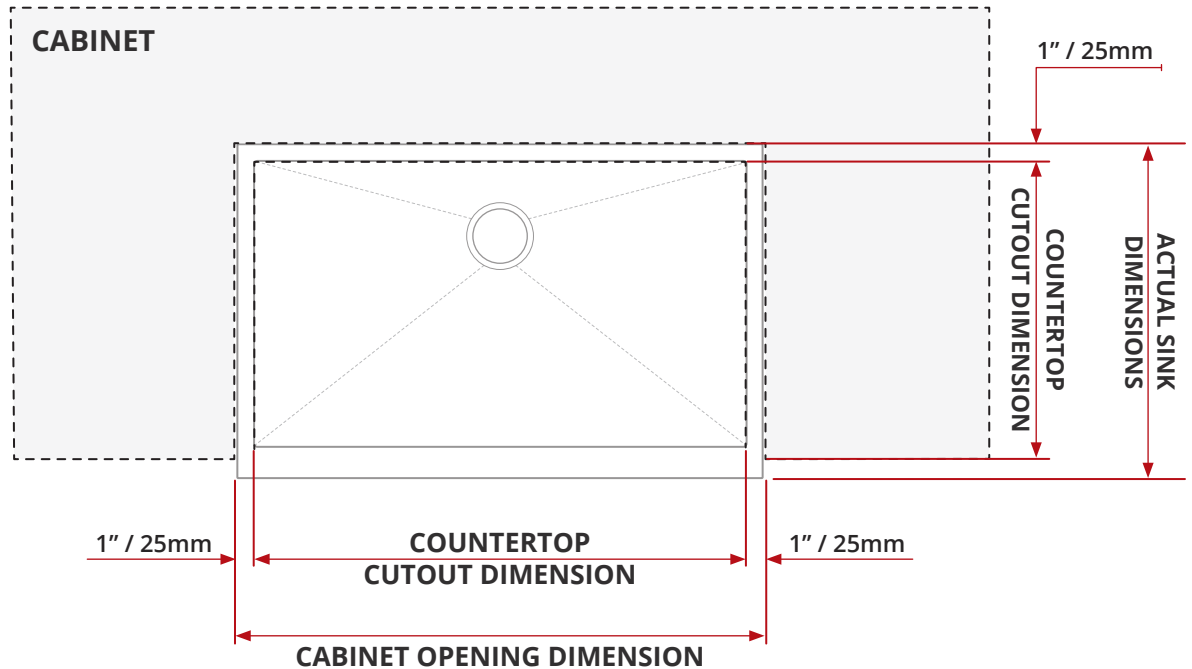

01

Please check actual template against physical sink unit for most accurate cut!

**CUTOUT
TEMPLATE**

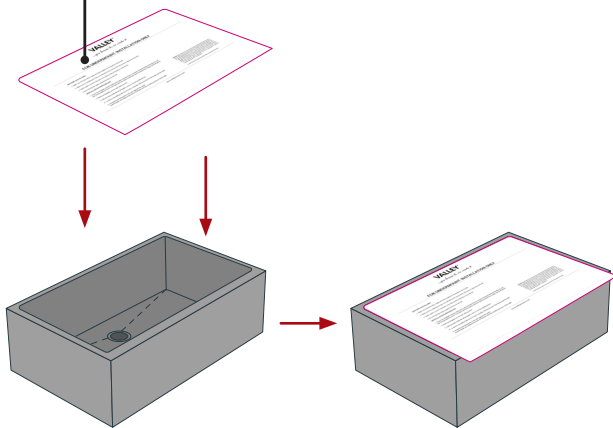

02

Place the template onto the countertop, and make sure that there is enough distance between the faucet and wall. Check whether there is enough space the space under the basin to install the supply and drain pipes.

**CUTOUT
TEMPLATE**

COUNTERTOP

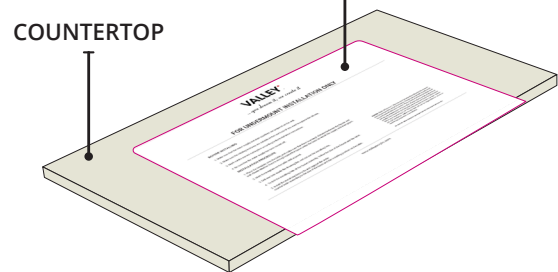

03

Draw a cutting line on the table with a pencil along the template.

COUNTERTOP

**CUTOUT
TEMPLATE**

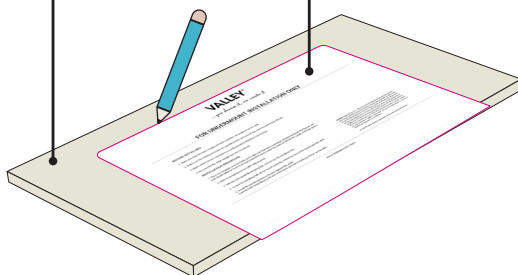

04

Drill one hole inside the marked cutting line, and cut out the countertop

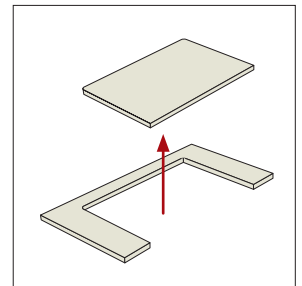

SAW

CUTTING LINE

COUNTERTOP

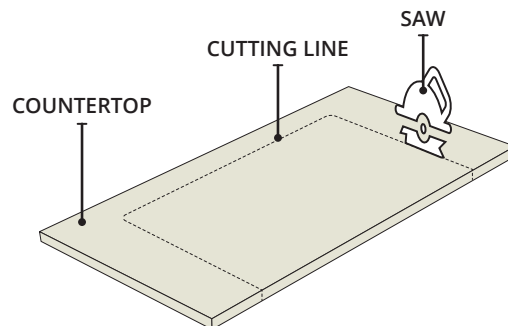

05 Install Support Framing

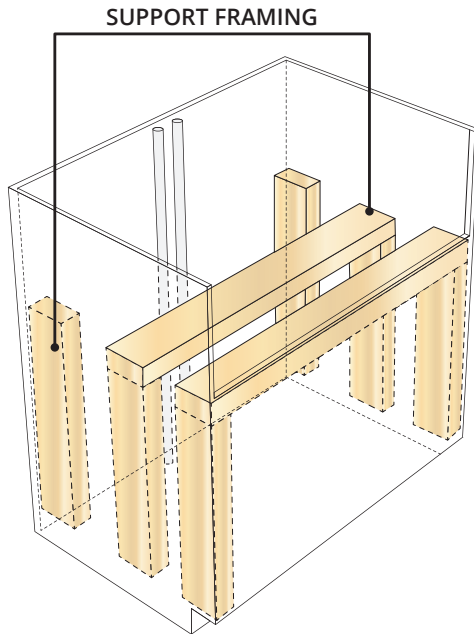

For proper countertop installation, the top of the sink must not extend above the top of the cabinet.

- Use 2x4s to construct support framing to extend along the inside walls on each side of the base cabinet. Make sure that the sink rim will sit at or slightly below the top of the cabinet.
- **Position and level the support framing.**
- Secure the support framing with construction adhesive and screws (not provided).
- Cut four lengths of 2x4 support framing to extend from the bottom of the installed supports to the cabinet floor.
- Secure the vertical supports with construction adhesive and screws (not provided).

06 Extra Support

We recommend building a little table inside the cabinet for extra support. This support could be a 3/4" thick board f wide enough to support the sink but leaving room at the back for the plumbing to fit down through.

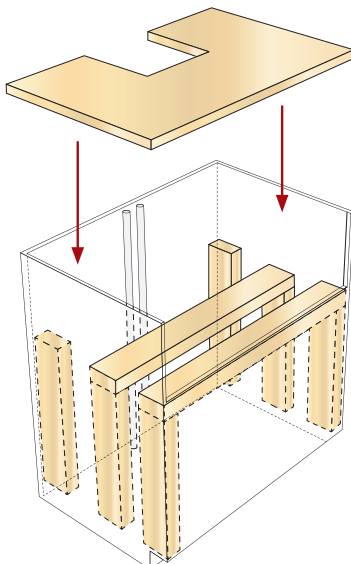

BACK SUPPORT FRAMING

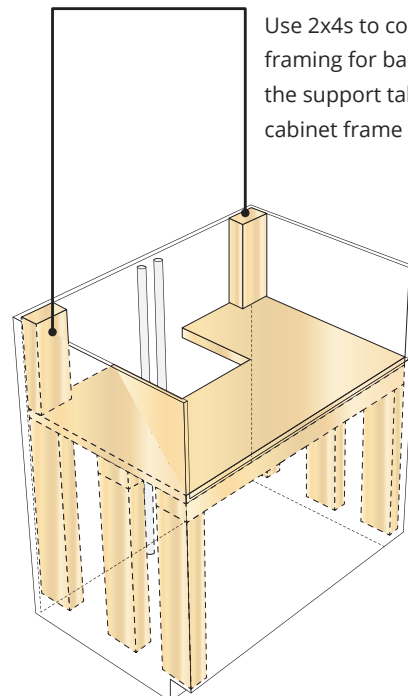

07 Install the kitchen sink

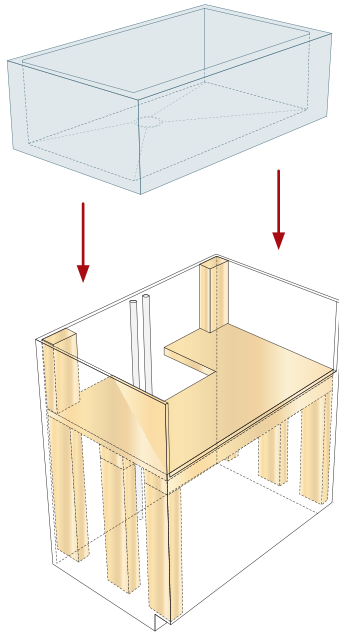

- Lower the sink into the cabinet. Verify that the sink is supported by the frame.

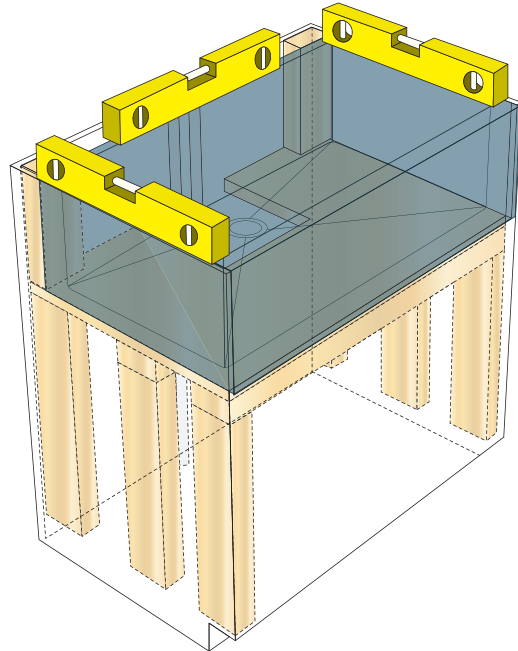

- Make sure that the sink is level. Make any necessary adjustments, and shim as needed.

- 08**
- Remove the sink from the cabinet.
 - Apply a bead of 100% silicone sealant to the top of each support

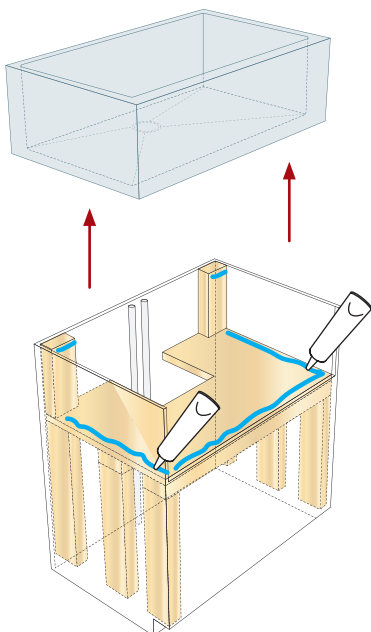

- 09**
- Lower the sink onto the supports, and push in to ensure that the apron is flush to the front of the cabinet.
 - Apply a bead of 100% silicone sealant to the sides and back of the kitchen sink as shown

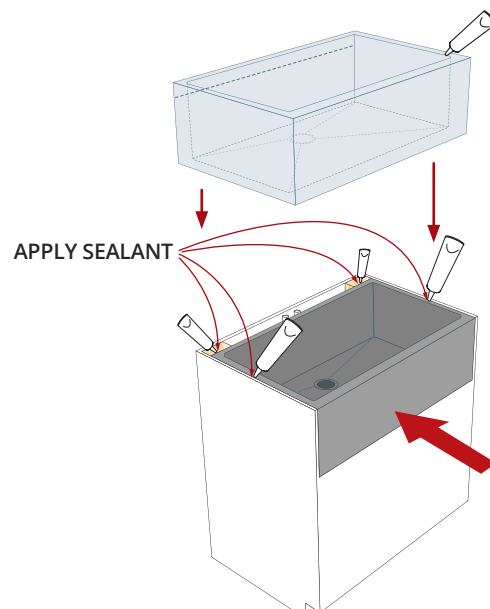

10

Apply a bead of 100% silicone sealant on top three sides rim as shown

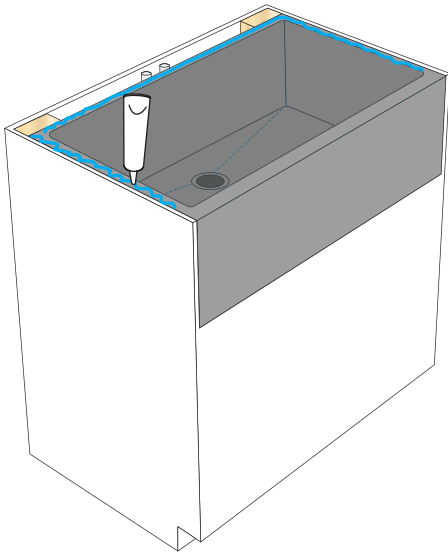

11

Install the countertop.

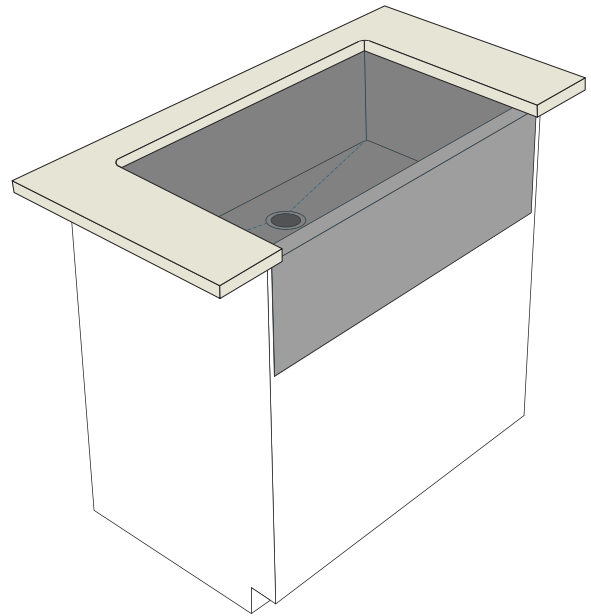

12

Apply a thin bead of 100% silicone sealant where the sink meets the countertop and cabinet.

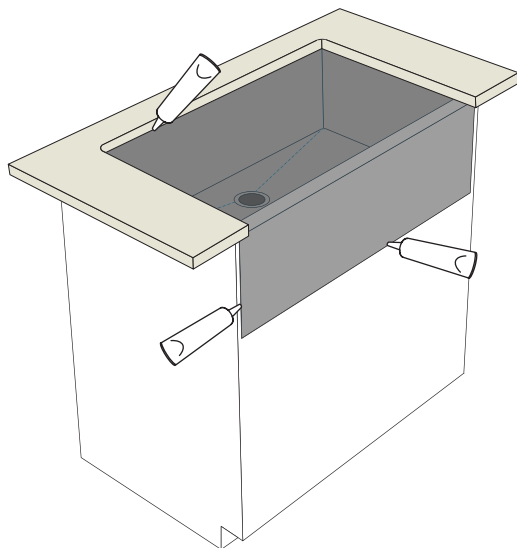

13

! IMMEDIATELY WIPE AWAY ANY EXCESS SEALANT. !

**24
HRS**

PLEASE ALLOW 24 HOURS FOR THE SILICONE TO FULLY CURE BEFORE USING THE KITCHEN SINK.

MAINTENANCE

- For daily cleaning, use hot soapy water and vinegar
- Clean any water stains and dirt using a soft cloth only to avoid scratching
- Avoid using any Acidic or Alkaline cleaners to prevent corrosion



Congratulations! You are now a part of the Valley Acrylic family, and an owner of a great product!