

ACRYLIC WALL PANEL INSTALLATION GUIDE



Thank you for choosing Valley Acrylic Bath. This installation manual provides general information on the installation of our products.

All the information in this guide is based upon the most recent product information available at the time of this publication. Valley Acrylic reserves the right to make changes to product characteristics, packaging, or availability at any time without notice.

Thank you for your purchase!

BEFORE YOU BEGIN

- Please read these instructions carefully before beginning your installation.
- Consult your local building codes to ensure that your installation complies with local standards.
- Remove the unit from its packaging. Before disposing, packaging and taking unit from your sales person, inspect the unit to make sure it is in good shape.
- Should inspection reveal any damage or defect in the finish, **Contact Us**. The warranty does not cover damages or defects in the finish once the unit has been installed. Valley's responsibility for shipping damages ceases upon delivery of the product in good order to the carrier. All complaints regarding damage due to transport must be made directly to the carrier.
- Do not remove the protective polyethylene film from your product until installation is completed to ensure maximum protection from inadvertent damage, except in areas where two surfaces will be in permanent contact.
- Please refer to your product's specification sheet and ensure that both your unit and build plan measure match the stated sizes.

REQUIRED TOOLS

- Measuring Tape
- Pencil.
- Jigsaw
- Circular saw or router
- Masking tape
- Painters tape
- Screwdriver
- Level.
- Safety glasses
- Water-resistant glue
- Silicone sealant



IMPORTANT INFORMATION

1. Panels must be thoroughly inspected upon receipt for damage or visible defects. The panels are supplied with a protective clear film, this should be peeled back to check for damage or discrepancies where necessary then replaced to provide protection during installation.

Do not install panels that you find to be defective.

2. Once the panels have been cut or installed we regard this as an acceptance of their quality and suitability for purpose and therefore we cannot accept any subsequent claims for faults or damage.
3. Panels should always be stored flat to avoid bowing. Panels should never be stored outside.
4. Acrylic panels can have extremely sharp edges and we advise that suitable gloves be worn for protection when handling and installing them.
Extra care should be taken when handling, dry jointing and installing larger or shaped panels that have cutouts in them as excessive flexing can cause cracking around the cut-outs.
5. Acrylic panels must be fitted to a continuous surface such as plaster board, existing tiling, chipboard & plywood sheathing and tile backers providing the surface it is sound, plumb and level. Some surfaces do require pretreatment before installation, tiles should be de-greased and fresh plaster should be sealed with a proprietary PVA sealer.

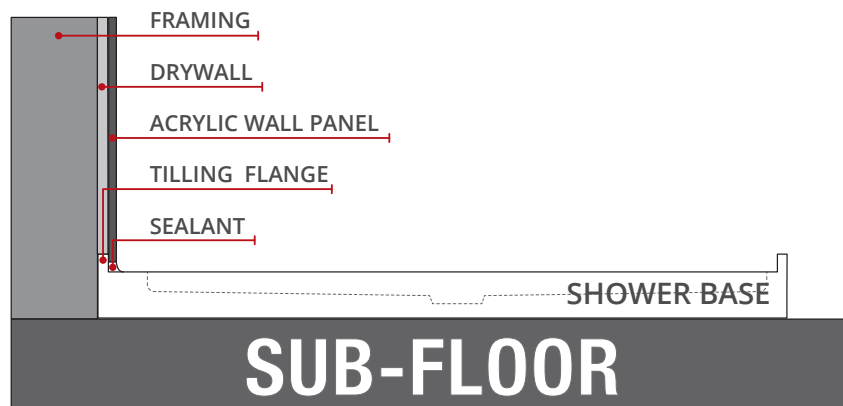

6. The Acrylic panels are subject to expansion and contraction during normal use so it is necessary to make allowances for this during installation. If the profiles are not being used then a 3mm gap should be left between the edge of the panel and any adjoining surface, this gap should then be sealed with silicone sealant.
7. Shaped cut-outs can be formed by drilling 8mm diameter holes in the corners of the required shape and then cutting between using a jigsaw with an acrylic blade. It is important that the panel is supported at all times. With all cut outs a radius of at least 4mm must be left in the corners failure to do this can lead to the acrylic cracking.

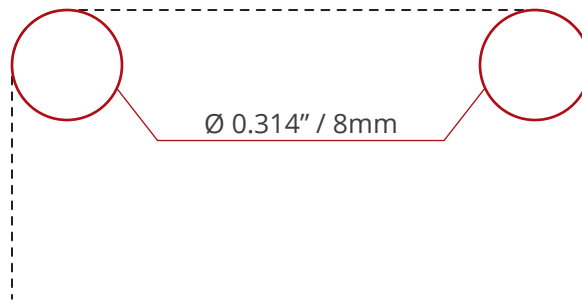

8. A clearance gap of 2-3mm all around should be allowed where pipes or fittings come through the panel even where collars are to be fitted. The gap should then be filled with sealant.

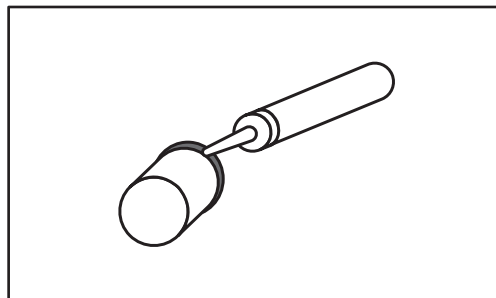

ACRYLIC PANEL INSTALLATION

01

Level and mark the position of the end of the panel directly on the wall. This will act as a guide when adding adhesive to the wall.

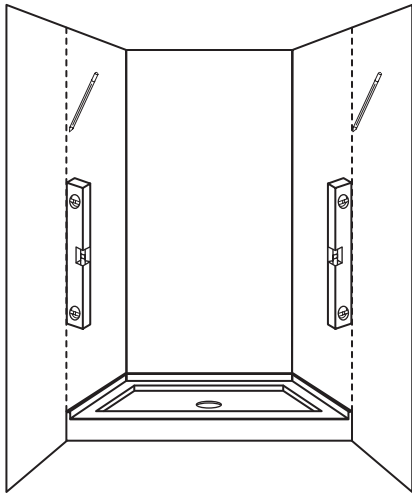

02

Measure the top, middle and bottom of the walls including the shower base and trim.

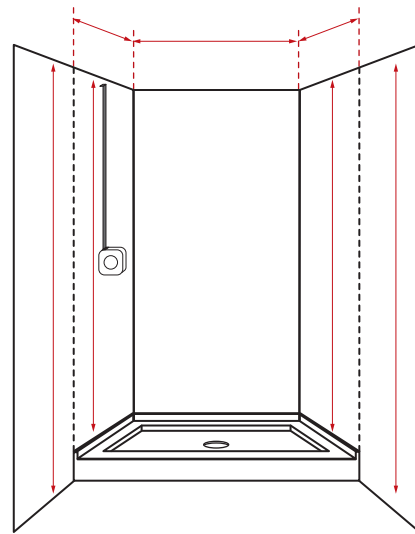

03

Mark the required measurements to the acrylic panels with a pencil and cut the panels to size.

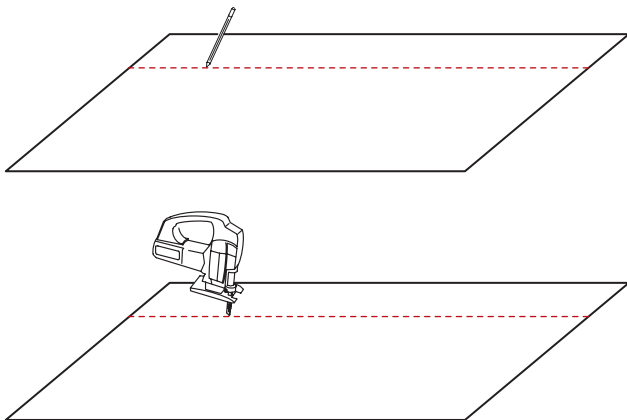

04

Add adhesive over the walls. Make sure all of the area is covered.

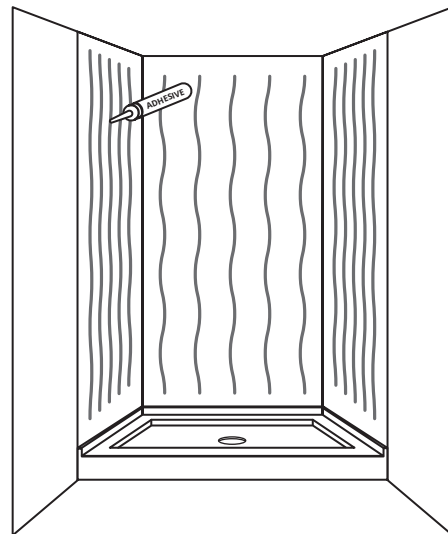

ACRYLIC PANEL INSTALLATION

05

Place the panels over the walls. Make sure to smooth out wall pockets of air. Apply pressure over the wall panels to ensure a good bond.

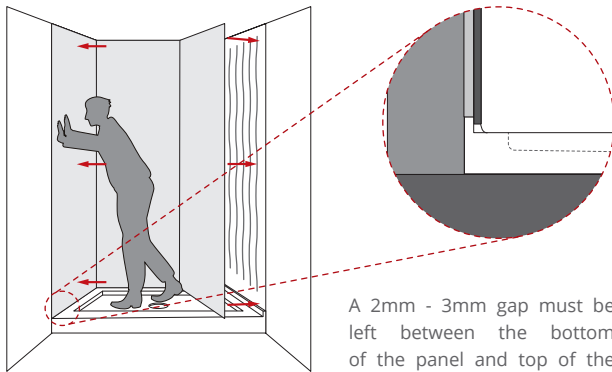

A 2mm - 3mm gap must be left between the bottom of the panel and top of the shower tray or bath, this can be achieved by using packers when fixing panels.



Apply weight evenly

06

Tape the acrylic panel edges with painters tape as shown



PLEASE ALLOW 24 HOURS FOR THE SILICONE TO FULLY CURE.

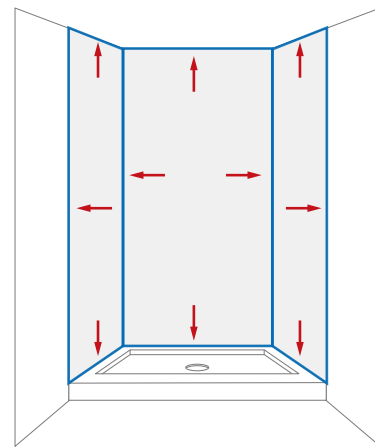

07

After the 24 hours, remove the masking tape. Make sure the acrylic panels are fully secured.

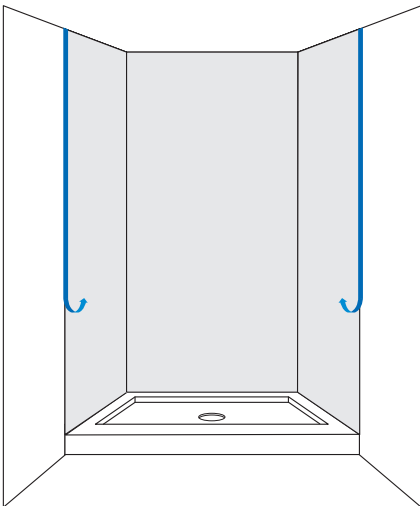

08

Fit both of the internal corner profiles to the edge of the panel by applying a bead of sealant into one channel of each of the profiles.

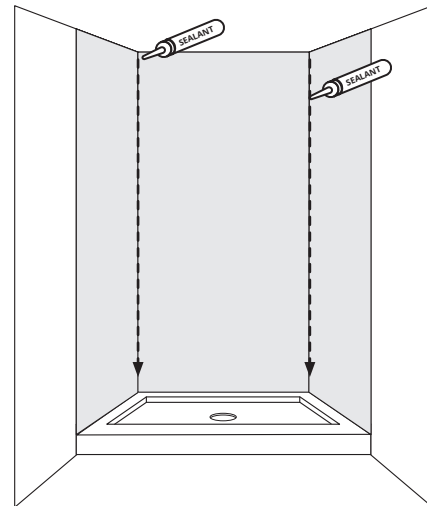

ACRYLIC PANEL INSTALLATION

09

The gaps should then be sealed ensuring that the silicone is forced into the void.

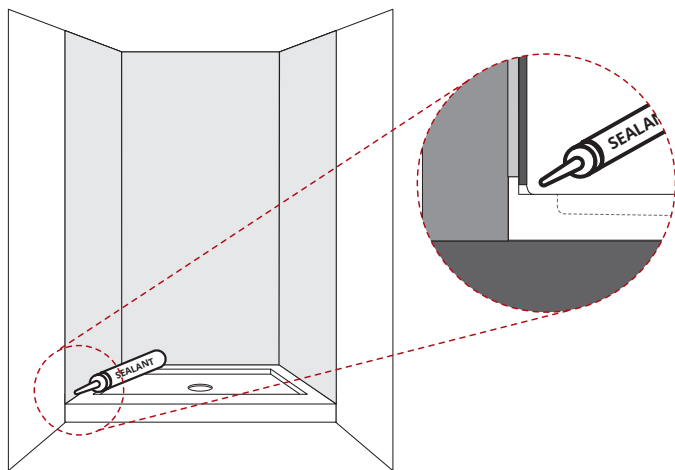

10

Wipe any excess of silicone with a warm soapy cloth.

**24
HRS**

PLEASE ALLOW 24 HOURS FOR THE SILICONE TO FULLY CURE.

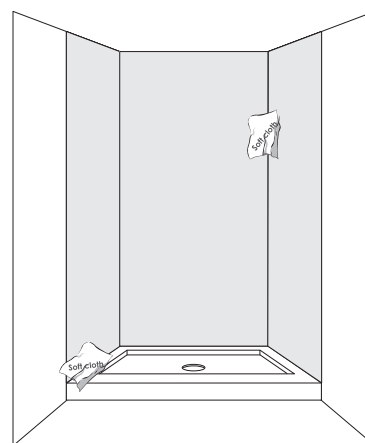

WARRANTY

Valley Acrylic offers the following express limited warranties on its products. These warranties extend only to the original owner/end-user for personal household use and start from the manufacturing date of the unit. For commercial uses, additional limitations apply.

This limited warranty, starting on the original purchase date, is only offered to the original purchaser who acquires the product directly from authorized Valley dealers. This limited warranty does not apply to cases in which a product was incorrectly installed, nor to damage due to negligence, misuse, thermal shocks, cigarette burn, fire, natural disasters or other accidents

Valley Acrylic wall acrylic panels have a limited warranty for residential use for a period of **10 years** from the original purchase date, against any failure from improper manufacturing defects.

The warranty does not extend to:

- damage caused by cleaning, maintenance, or installation performed other than strictly in accordance with the information contained in the Instructions;
- damage caused by the use of strong chemicals;
- gloss reduction, scratching, or staining of the finish over time due to water impurities or atmospheric conditions;
- damage due to installation error, product neglect, misuse, or abuse, accident, or negligence, whether caused by the purchaser, a contractor, or a service provider, or any other cause beyond the control of Valley.

The company will replace or repair the defective product subject to the following conditions:

- Claim is made in writing to head office within 10 days of the problem being apparent;
- The product has been used in the manner that it was intended, this protection does not apply to any products that have been misused in any way;
- The product must have been installed and cared for in line with our instructions



Congratulations! You are now a part of the Valley Acrylic family, and an owner of a great Canadian-made product!