

INSTALLATION GUIDE

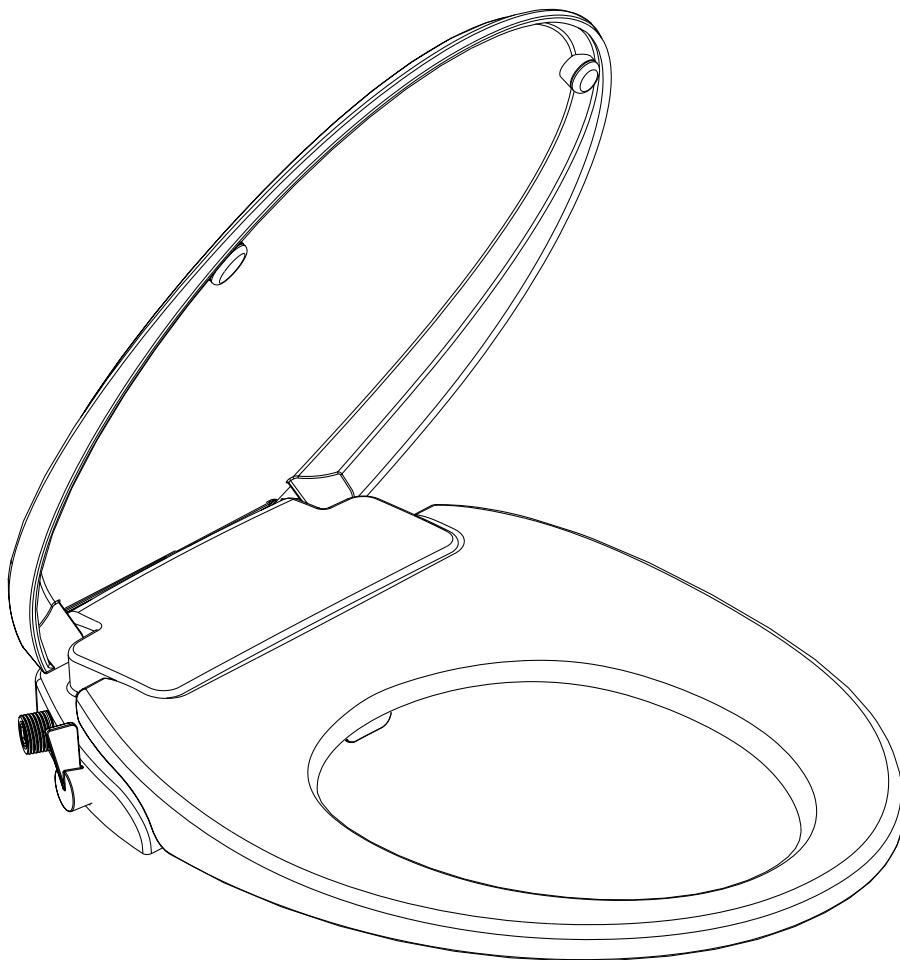

INSTALLATION GUIDE

Thank you for choosing Valley Acrylic Products. This installation manual provides general information on the installation of our products.

BEFORE YOU BEGIN

- Read the instructions carefully before beginning the installation.
- Consult local building codes to make sure the installation complies with standards.
- Remove the unit from its packaging. Before disposing, packaging and taking unit from your sales person, inspect the unit to make sure it is in good shape.
- Should inspection reveal any damage or defect in the finish, Contact Us. The warranty does not cover damages or defects in the finish once the unit has been installed. Valley's responsibility for shipping damages ceases upon delivery of the product in good order to the carrier. All complaints regarding damage due to transport must be made directly to the carrier.
- It is recommended that you place the unit in the bathroom before you start. Sectional units should be disassembled if necessary. Conserve all nuts and bolts.

REQUIRED TOOLS



WRENCH



SCREWDRIVER

INCLUDED PARTS

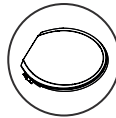

LID

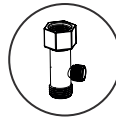

T-SHAPE JOINT

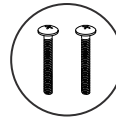

BOLTS

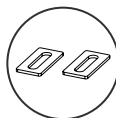

WASHERS

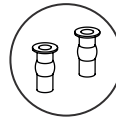

PLASTIC NUTS



MOUNTING
BRACKET

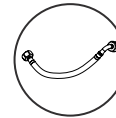

FLEXIBLE HOSE

INSTALLATION GUIDE

ASSEMBLY DRAWING

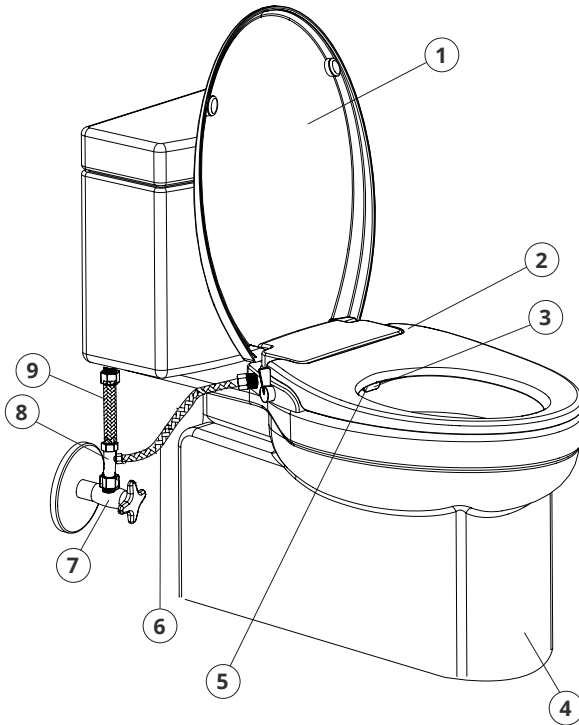

1. LID
2. SEAT
3. FRONT WASH NOZZLE
4. BOWL
5. REAR WASH NOZZLE
6. FLEXIBLE HOSE
7. ANGLE VALVE
8. ADAPTOR
9. CONNECTING HOSE

SPECIFICATIONS

| | |
|----------------------|-------------------------------|
| FRONT WASH FLOW RATE | 0.6 - 1.4 LPM |
| REAR WASH FLOW RATE | 0.6 - 1.4 LPM |
| WATER SUPPLY | Water hose delivery |
| WATER PRESSURE RANGE | Static pressure: 0.05-0.8 MPa |



CAUTION

PLEASE DO NOT DISASSEMBLE, REPAIR OR REMODEL THE PRODUCT.

THE WATER SUPPLY MUST BE DRINKING WATER RATHER THAN RAIN WATER, GREY WATER OR CYCLE WATER.

INSTALLATION GUIDE

- 01** Begin by placing the nuts into the fastening holes on the bowl, ensuring they are pressed flat.

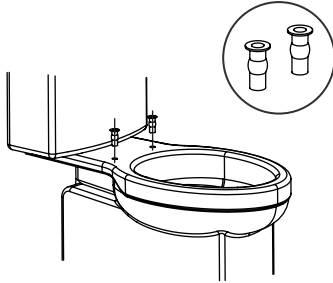

- 02** Take the mounting bracket and position it onto the bowl. Adjust the position of the washers to align the bolts with the nuts. Once aligned, gently tighten the bolts.

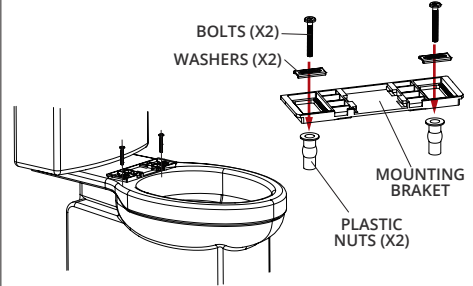

- 03** Insert the bidet seat onto the mounting bracket, pushing it until it reaches the end. You will hear a "click" sound, indicating that it is securely fixed. Adjust the position of the bidet seat to align with the outline of the bowl.

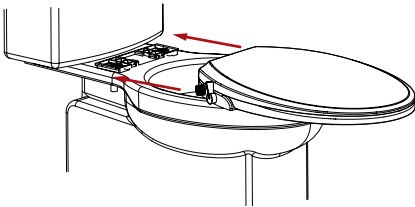

- 04** To remove the bidet seat, hold down the side button and pull it outward.

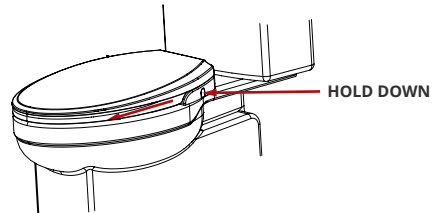

- 05** Grab a screwdriver and firmly tighten the bolts until they can no longer be screwed.

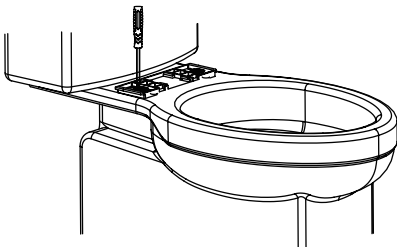

- 06** Once again, insert the bidet seat onto the mounting bracket, pushing it to the end until you hear a "click" sound, ensuring it is securely fixed.

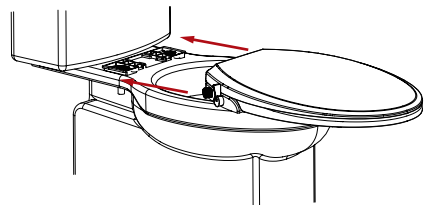

INSTALLATION GUIDE

- 07** Turn off the water valve near the toilet.

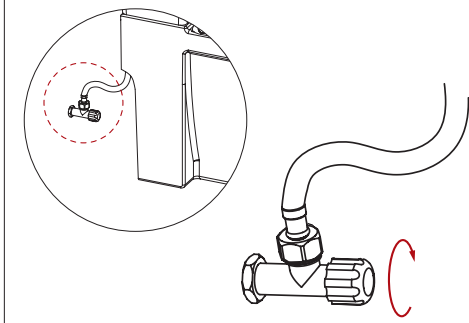

- 08** Flush your toilet to drain the tank completely. Hold down that flusher until it empties! (A couple inches of water is okay.)

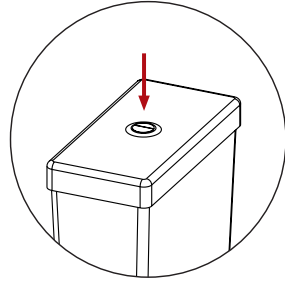

- 09** Disconnect the existing flexible hose from the valve. To unscrew the connection, turn left.

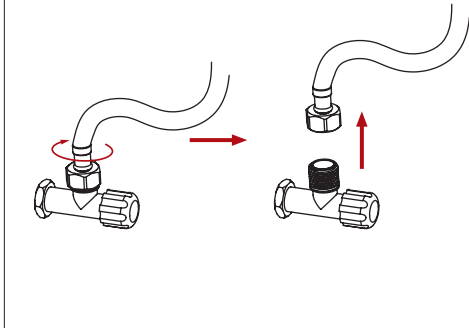

- 10** Place the rubber washer in the T-Shape joint. Screw it onto the valve connection and then attach the flexible hose to the top of the T-Shape joint. **Do not over tighten**

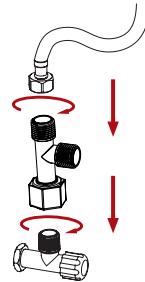

- 11** Attach the the hose into the T-Shape joint and secure with the lock nut. Connect the other end of the hose into the bidet and secure.

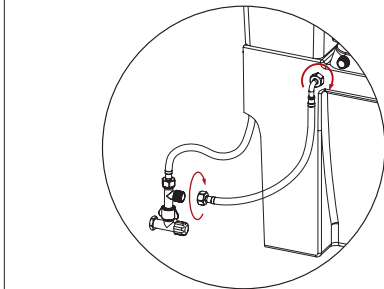

- 12** Make sure all the connections are secure and turn on the water supply.

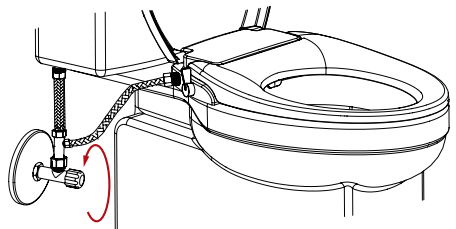

INSTALLATION GUIDE

- 14** Once all water connections have been made, check for possible leaks.



- 15**

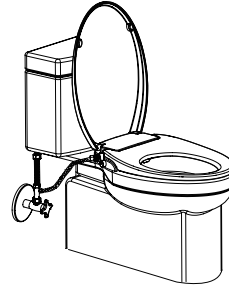

ENJOY YOUR CSB-SC69
VALLEY SOFT CLOSING SEAT BIDET

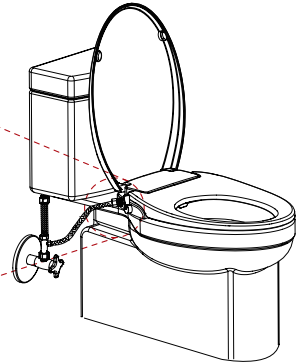
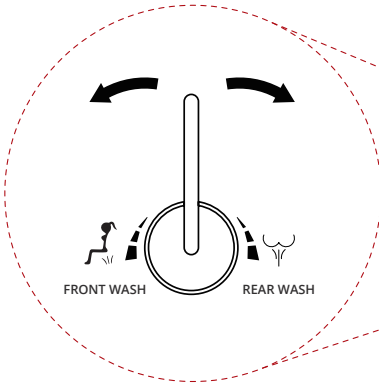

REAR WASH

1. Turn the knob clockwise while seated.
2. Turn the knob to adjust the water flow according to personal needs.



SELF CLEANING NOZZLES

Each time the knob is used, the nozzle will undergo a quick and automatic self-cleaning cycle, ensuring optimal hygiene and functionality.



FRONT WASH

1. Turn the knob counterclockwise while seated.
2. Turn the knob to adjust the water flow according to personal needs.



TURN OFF

Turned the knob to a vertical position

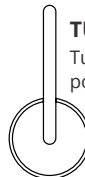

MAINTENANCE

SURFACE CLEANING

Use a smooth sponge/cloth with diluted kitchen detergent to clean the product. The following things are forbidden to use for surface cleaning: hydrogen chloride detergent, painting thinner, benzene, abrasive paper, polishing agent, fragrance and insecticide, etc.

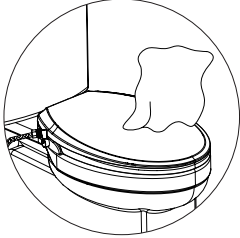

NOZZLE CLEANING

Pull out the nozzle softly and use cloth/sponge or toothbrush with kitchen detergent to clean it.

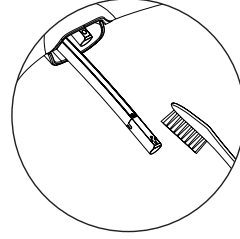

NOZZLE REPLACEMENT

1. Pull out the nozzle softly and hold the tube. Remove the nozzle along the arrow direction as **figure A**.
2. Hold the tube and insert the new nozzle along the arrow direction as **figure B**

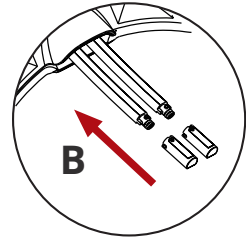
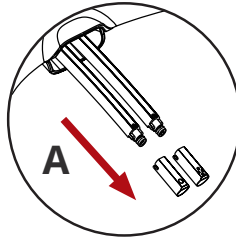
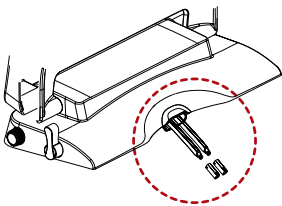

INSTALLATION GUIDE



Congratulations! You are now a part of the Valley Bath & Kitchen family.



TROUBLESHOOTING

| ISSUES | CAUSE | SOLUTION |
|---|---|--|
| Low water flow | Water flow level is in the minimum level | Adjust water flow to the maximum level |
| | Low water pressure | When the water pressure is lower than 0.05MPa, please contact local department if it still doesn't work |
| The spray nozzle have no water | The water valve is turned off | Turn on the water valve. |
| | The filter screen in the flexible hose is stuck | Clean the filter screen in flexible hose |
| | The Nozzle is stuck | Take off the nozzle and clean it. |
| | The water supply pressure is too low | Increase the external water pressure |
| Water leaks from the bidet seat base part | The water supply pressure is too high | The maximum water pressure of this product is 0.8MPa. If water supply pressure is higher than 0.8MPa, please contact the local department for solution |

Valley Bidets are warranted for residential use for a period of 1 year from the original purchase date, against any failure from improper manufacturing defects.