

### INSTALLATION GUIDE

Thank you for choosing Valley Acrylic Bath Ltd Products. This installation manual provides general information on the installation of our products.

#### BEFORE YOU BEGIN

- Read all instructions before beginning installation.
- Consult local building codes to make sure the installation complies with standards.
- Remove the unit from its packaging. Before disposing of packaging , inspect the unit to make sure it is in good condition.
- Should inspection reveal any damage or defect in the finish, Contact Valley Acrylic Bath Ltd. at 1-877-398-8827 . The warranty does not cover damages or defects in the finish once the unit has been installed. The manufacturers responsibility for shipping damages ceases upon delivery of the product in good order to the carrier. All complaints regarding damage due to transport must be made directly to the carrier.



#### **CAUTION**

**RISK OF PERSONAL INJURY OR PRODUCT DAMAGE. HANDLE WITH CARE. PRODUCT CAN BREAK, CHIP OR CAUSE INJURY IF HANDLED CARELESSLY.**

**WE RECOMMEND THE INSTALLATION OF THIS PRODUCT BE DONE BY A LICENSED PROFESSIONAL PLUMBER.**

### INSTALLATION GUIDE

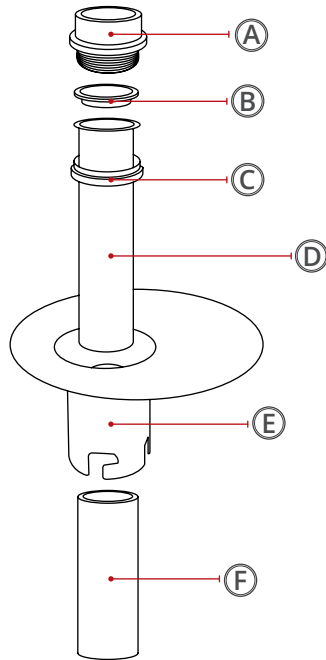

- (A) 1 1/2" male and female adaptors
- (B) Gasket
- (C) Nut
- (D) Easy Drain
- (E) Threaded brass tailpiece
- (F) ABS or PVC pipe

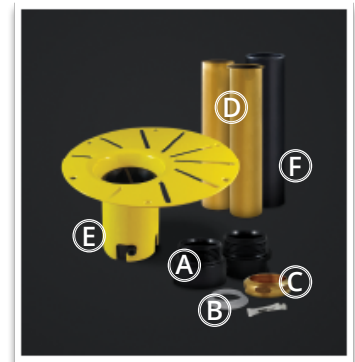

### SPECS

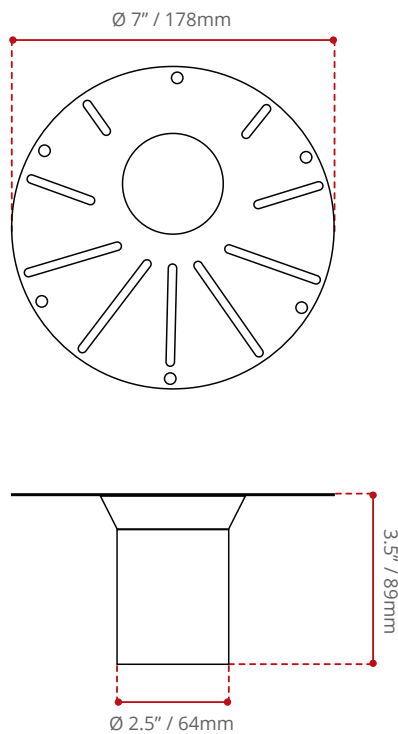

DISCLAIMER:  
Measurements may vary  $\pm \frac{1}{4}"$   
(Diagram Not to scale)

### EASY DRAIN INSTALLATION GUIDE

- 01** Mark on the wood sub-floor the cutting location for the drain flange.

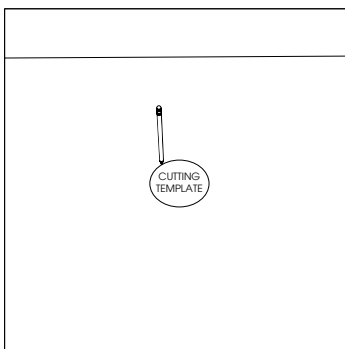

- 02** Cut 6-1/2" (16.5mm) hole into the wood sub-floor for the drain flange.

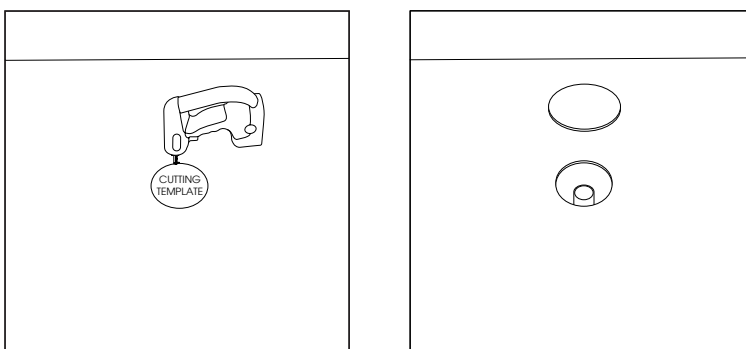

- 03** Assemble the drain (EasyDrain) • Insert assembly into floor opening.

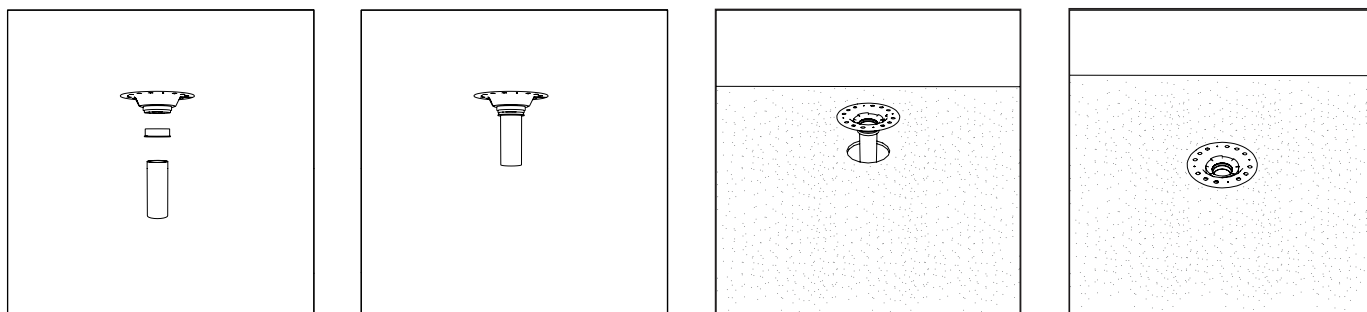

### EASY DRAIN INSTALLATION GUIDE

- 04** Screw the drain (EasyDrain) into place. • Install the Ceramic Tiles.

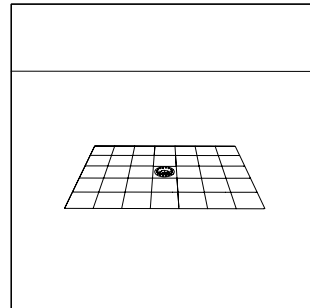
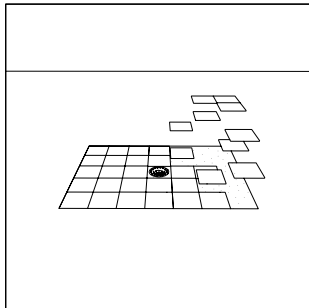
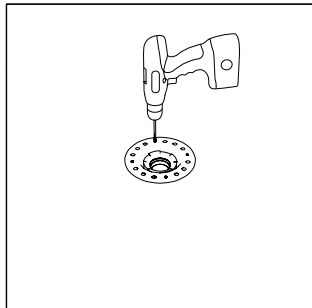

- 05** **FREESTANDING TUB INSTALLATION - TWO PEOPLE REQUIRED**  
Turn the tub upside down for an easy installation. • Ensure you have the correct Waste & Overflow.

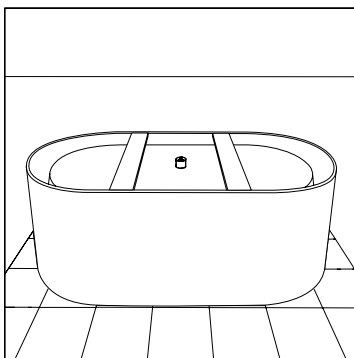

- 06** Affix the appropriate brass tailpiece to the waste & overflow.  
**DO NOT CUT THE SUPPLIED BRASS TAILPIECE, DOING SO MAY CAUSE A LEAK.**

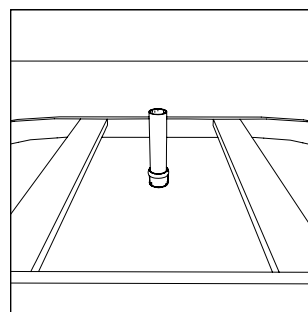
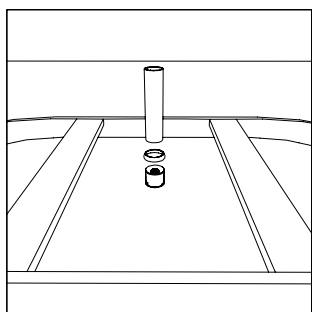

### EASY DRAIN INSTALLATION GUIDE

- 07** Ensure the measurements between the base of the drain and the P-Trap will accommodate the tailpiece.  
**APPLY LUBRICANT TO THE TAILPIECE**

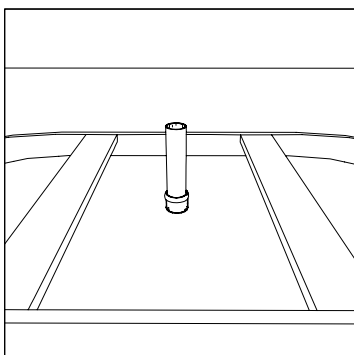

- 08** Once the tailpiece is been installed on the waste & overflow, position the Tub and tailpiece in-line with the drain.

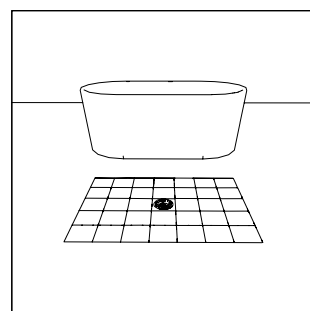
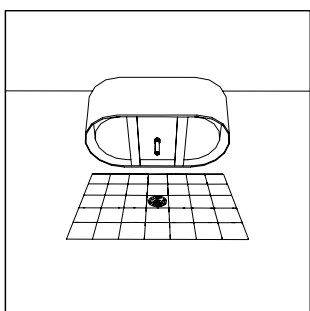

- 09** Carefully lower the tub with the installed brass tailpiece as vertical as possible into the red collar in drain assembly.

