



Product images are for illustration purposes only. Actual product(s) may vary.

DESCRIPTION:

- Above counter Shila Stone basin
- Default finish Gloss white
- With overflow
- Drain assembly sold separately
- Wall-mount option available
- Stain, scratch and crack resistance
- Designed in Canada
- Complies with CSA & IAPMO standards

DEFAULT FINISHES

GW
 GLOSS WHITE
 (R-400GW)

UPCHARGES

WM
 WALL MOUNT

SHIPPING INFORMATION:

- Length: 19" / 483mm
- Net Weight: 7.1 kg / 15.65 lbs.
- Width: 11" / 279mm
- Gross Weight: 7.7 kg / 17 lbs.
- Height: 7.5" / 191mm

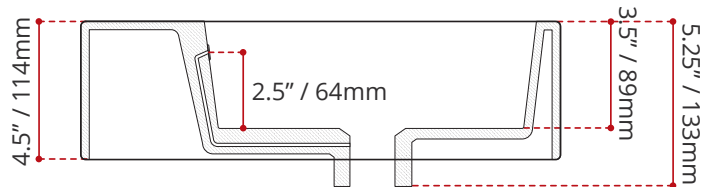
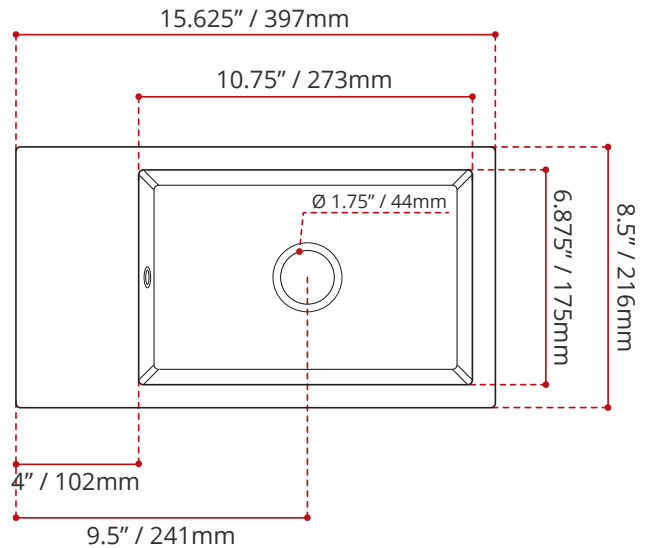

DISCLAIMER: Measurements may vary ± 1/4" (Diagram Not to scale)

BASIN VARIATIONS

ALL UPCHARGE OPTIONS ARE MADE TO ORDER - NO REFUND - NO RETURN -

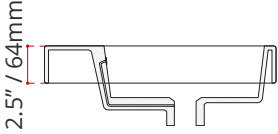
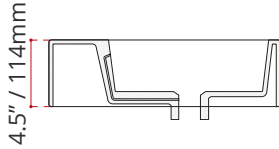
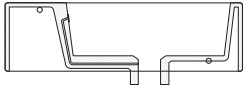
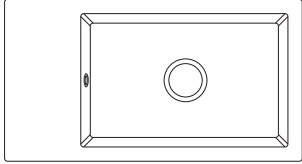
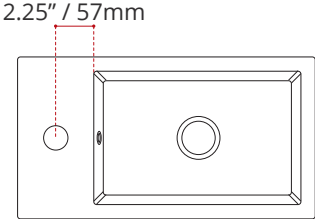
		LIP SIZE OPTIONS		WALL MOUNT	
		2.5" LIP Drop-In Cutting Required	4.5" LIP Drop-In Cutting Required	WM	
R-400W 		 <p>2.5" / 64mm</p>	 <p>4.5" / 114mm</p>		
FAUCET HOLE DRILLING OPTIONS	NH NO HOLE 	(GLOSS WHITE FINISH)	R400GW25-NH	R400GW45-NH	R400GW45WM-NH
	1H 1 HOLE  <p>2.25" / 57mm</p>	(GLOSS WHITE FINISH)	R400GW25-1H	R400GW45-1H	R400GW45WM-1H