

DESCRIPTION:

- Single bowl 10° radius kitchen sink
- Undermount install
- Handcrafted from T-304 brushed stainless steel
- Durable commercial-grade **16 gauge** thickness
- Off-set Back Drain location
- Drain groove design
- StoneGuard undercoated over rubber pad
- Sink grid and basket strainer included

MINIMUM CABINET SIZE:

32" / 813mm

SINK GRID OPTION

BG6842

FINISH:



BRUSHED STAINLESS STEEL

SHIPPING INFORMATION:

- Length: 31" / 787mm
- Net Weight: 13 kg / 29 lbs.
- Width: 21" / 533mm
- Gross Weight: 16 kg / 35 lbs.
- Height: 13.5" / 343mm

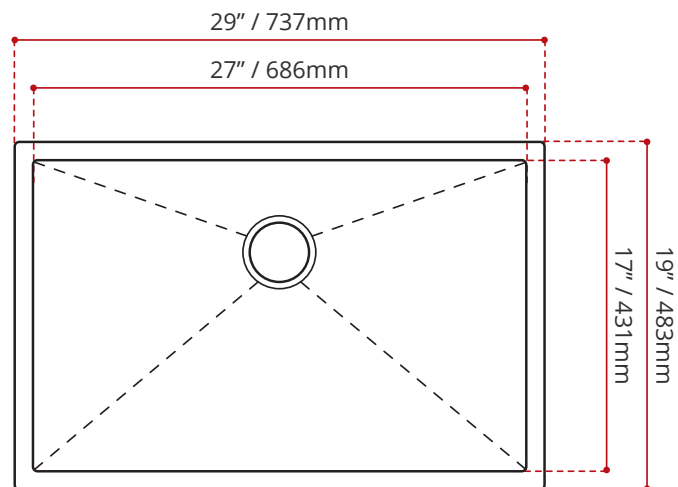

DISCLAIMER:
Measurements may vary $\pm \frac{1}{4}$ "
(Diagram Not to scale)