

INSTRUCTION MANUAL

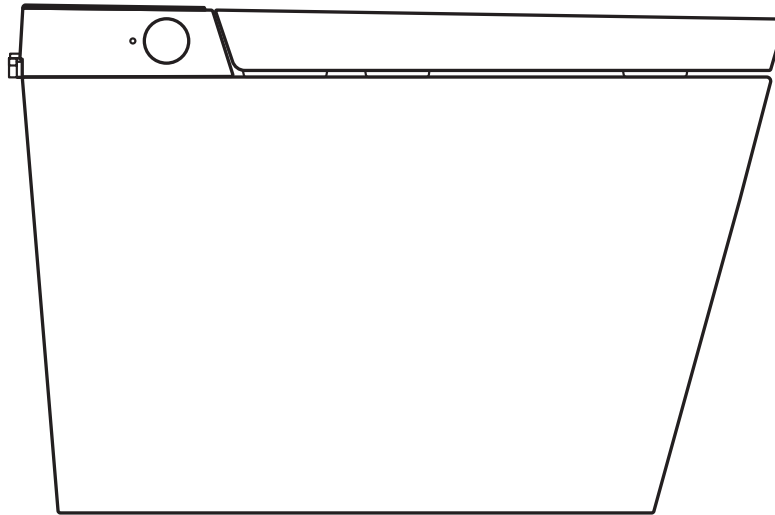

INSTRUCTION MANUAL

Thank you for choosing Valley Acrylic Products. This installation manual provides general information on the installation of our products.

BEFORE YOU BEGIN

- Read the instructions carefully before beginning the installation.
- Consult local building codes to make sure the installation complies with standards.
- Remove the unit from its packaging. Before disposing, packaging and taking unit from your sales person, inspect the unit to make sure it is in good shape.
- Should inspection reveal any damage or defect in the finish, Contact Us. **The warranty does not cover damages or defects in the finish once the unit has been installed.** Valley's responsibility for shipping damages ceases upon delivery of the product in good order to the carrier. All complaints regarding damage due to transport must be made directly to the carrier.
- It is recommended that you place the unit in the bathroom before you start. Sectional units should be disassembled if necessary. Conserve all nuts and bolts.



**PLEASE DO NOT DISASSEMBLE, REPAIR OR REMODEL
THE PRODUCT.**

**THE WATER SUPPLY MUST BE DRINKING WATER RATHER
THAN RAIN WATER, GREY WATER OR CYCLE WATER.**

INSTRUCTION MANUAL

TECHNICAL SPECIFICATION

RATED VOLTAGE	110V
RATED FREQUENCY	60Hz
RATED POWER	1100W*
WATER CONSUMPTION	4 Star
DUAL FLUSH	4.5 / 3 L
SUPPLY WATER PRESSURE	0.18 - 0.5 MPa
MINIMUM WATER PRESSURE	0.18MPa, and the minimum water flow should be 20 L/Min
CODES / STANDARDS	IEC /EN 60335-1 IEC/EN 60335-2-84 AS/NZS60335.2.84

WARM WATER TEMP.	4 Levels (Room Temperature-40°C)
WARM AIR TEMP.	4 Levels (Room Temperature-60°C)
HEATED SEAT TEMP.	4 Levels (Room Temperature-40°C)
ENVIRONMENT TEMP	5-40°C
WARM WATER HEATING METHOD	Instant Heating
WATER PROOF LEVEL	IPX4
WATER ENTRY TEMPERATURE	1-35°C

* Power value testing condition:

- Water Pressure: 0.2MPa,
- Inlet Water Temperature: 35°C
- Water Flow: 600ml/min.

• Max temperature of the water supplied by the product for hygiene: 42°C

• There will be no further notice if any technical specification changed due to product improvement and technical update, all real technical specification should be subject to the final product.

SAFETY PRECAUTIONS

Please read the “safety precautions” carefully before use, all the precautions listed here are connected to safety. It’s important and must be followed.

The VA-S88 smart toilet is designed for optimal usage and safety. It is recommended that individuals, including children, who have reduced physical, sensory, or mental capabilities, or lack experience and knowledge, should use the appliance under the supervision or with proper instructions from a responsible person. This ensures their safety and helps them make the most of the smart toilet’s features.

WARNING

Please **DO NOT** disassemble, repair or alter. **DO NOT** use tools in places other than designated.

- Doing so may cause fire, electrical shock, overheating, short circuit or breakdown.

Please **DO NOT** get any water or cleaning solution on the main unit or connection of power cord.

- Doing so may cause fire, electrical shock, heat or short circuit.
- Doing so may cause the product to crack resulting in injury or water damage.

Please **DO NOT** use the product if a malfunction occurs.

• In case of breakdown or other problems, be sure to cut off power by flipping the power switch to OFF. Close the water shutoff valve to stop water supply.

Possible malfunctions:

- Water is leaking from a pipe or the main unit.
- The product is cracked or broken.
- The product makes a strange noise or emits a strange odor.
- The product emits smoke.
- The product is abnormally hot.
- The toilet seat cushion is out of place.
- Continued use after malfunction could cause a fire, electric shock, heat, short circuit, injury or water damage.

• Continued use after malfunction could cause a fire, electric shock, heat, short circuit, injury or water damage. Please contact to the professionals.

- The recommended service life of smart toilet is 7 years. Please pay attention to the toilet working conditions after 7 years

Please **USE** tap water only.

• The use of alternative types of water may lead to skin irritation and potential malfunctions of the device. By adhering to this guideline and utilizing tap water, you can maintain optimal functionality and promote a safe and comfortable experience while using the smart toilet.

Please **DO NOT** a loose and unstable power socket.

- Doing so may cause fire or electrical shock.

Please insert the power plug into the AC 110V to 60Hz and 15A or above socket.

• Failure to do so may result in fire or electric shock. When the power exceeds the socket specification, it will cause the socket to heat and cause a fire.

Please **DO NOT** do anything that may damage the power plug.

Please **DO NOT** strike, yank, twist, excessively bend, damage, alter, or heat the power cords.

Please **DO NOT** place anything heavy on, bind or pinch the power cords.

- Using a damaged power cord may result in a fire, electrical shock, heat or short.

INSTRUCTION MANUAL

WARNING

This product is an electrical device. Do not install it in areas where water is likely to come into contact with the product or where high humidity may cause water to form on its surface.

It is crucial to prevent water damage, which can lead to fire or electrical shock hazards. When installing the product in a bathroom, it is recommended to have a fan or ventilation port in place to ensure good air circulation within the bathroom.

This helps to maintain a safe environment and prevent the buildup of excess humidity. In case the power cord gets damaged, it is important to prioritize your safety by contacting the manufacturer's repair department or an equivalent specialist for a proper replacement.

Avoid using the product with a damaged power cord to prevent any potential dangers.

Ensure that children are supervised and discouraged from playing with the appliance.

It is important to prevent any misuse or accidents by keeping children away from the smart toilet and providing proper supervision.

The appliance is not intended for use by individuals, including children, with reduced physical, sensory, or mental capabilities, or those lacking experience and knowledge, unless they have received appropriate supervision or instruction.

This guideline promotes safety and helps prevent any potential hazards or misuse of the smart toilet. To avoid the risk of low-temperature burns, it is advisable not to sit on the toilet for extended periods of time.

Prolonged contact with the seat may cause discomfort or burns, so it is recommended to use the toilet as intended and avoid excessive sitting.

Earth the appliance by connecting it to a properly grounded power supply unit.

- Ensuring a proper connection to the ground is crucial to prevent electric shock hazards.

Avoid raising the toilet seat or lid while objects are resting on top of the unit.

- Doing so may cause the main unit to become loose and fall, resulting in potential injury.

Refrain from leaning on the cover while using the device to prevent damage.

- Applying excessive force on the cover can lead to product damage or malfunction.

Keep cigarettes and other open flames away from the product to prevent fire hazards.

- Failing to do so may result in a fire incident.

Avoid applying strong force, mechanical shock, stepping on, or standing on the toilet seat, toilet lid, or main unit. Additionally, do not place heavy objects on these parts.

- Such actions may cause cracking, loosening of the main unit, and potential injury or water damage.

Ensure that the warm air openings of the product are not blocked by fingers or other objects.

- Blocking the warm air openings can lead to electric shock, personal injury, or damage to the product.

Do not fold or crush the water supply hose or damage it with sharp objects to prevent water leaks.

- Mishandling the water supply hose may result in water leakage.

INSTRUCTION MANUAL

WARNING

When maintaining the plastic parts or the water supply hose, use a neutral kitchen detergent diluted with water. Avoid using toilet cleaner, household cleaner, benzene, paint thinner, powdered cleanser, or nylon scrubbing brushes.

- Using these items may damage the plastic parts, cause injury, or lead to malfunctions.

To prevent sudden water leaks, avoid removing the water filter drain valve when the shutoff valve is open.

- Removing the water filter drain valve in such a situation will cause water to spurt out.

When installing the water filter drain valve, ensure it is securely tightened in its proper position to prevent water leaks.

- Failing to securely tighten it may result in water leakage.

If a water leak occurs, always close the shutoff valve.

During freezing temperatures, take measures to prevent damage to pipes and hoses.

- Frozen water pipes can cause the main unit and pipes to break, resulting in water leakage. Regulate the room temperature and drain the water to prevent freezing.

Avoid exposing the product to direct sunlight, as it may cause color changes or malfunction.

- Direct sunlight exposure can affect the appearance and functionality of the product.

Refrain from urinating on the main unit, toilet seat, or wand to avoid failures or discoloration.

- Such actions may lead to malfunctions or undesirable effects on the product.

Disconnect the power cord during thunderstorms to prevent any electrical hazards.

When not using the product for an extended period, close the shutoff valve and turn off the power.

Ensure the water pressure falls within the range of 0.14MPa-0.5MPa for proper operation.

- Maintaining the recommended water pressure is necessary for optimal performance.

Use the water supply hose provided with the product and avoid reusing old hoses.

- Old water supply hoses may not meet the product's requirements and should not be reused.

Keep the remote control away from water during daily use to prevent water damage. After each use, place the remote control back on its holder.

- Protecting the remote control from water exposure helps maintain its functionality and prevents damage.

Replace the batteries of the remote control when they are worn out after prolonged use.

INSTRUCTION MANUAL

The contents described in this manual include but are not limited to product material, process, functional characteristics, etc., which may be different from the actual product due to process improvement or product upgrade. Please refer to the actual product.

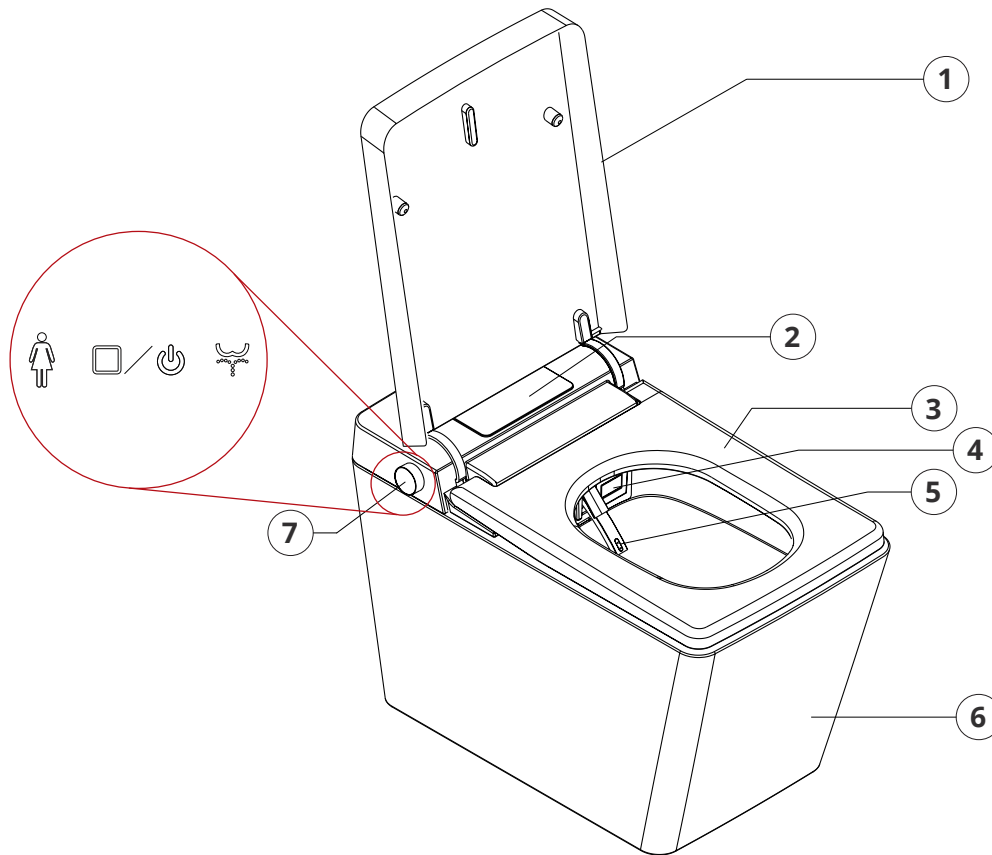

1. LID
2. DISPLAY SCREEN/ STATUS LED
3. HEATED SEAT
4. WARM AIR DRYER
5. SPRAY WAND
6. TOILET BOWL
7. SIDE CONTROL PANEL/KNOB

SIDE CONTROL KNOB STYLE:

There are 4 functions of the side control knob:

- DRYER/FLUSH • REAR WASH • LADY WASH • STOP

When the toilet is NOT occupied:

- Press the knob to flush.
- Press and hold the knob for 5 seconds to power on/off the toilet.

When the toilet is occupied:

- Turn the knob clockwise to activate spray wand and start rear wash.
- Turn the knob anti-clockwise to activate spray wand and start lady wash.
- Press and hold the knob for 3 seconds, the toilet will start to activate the dryer followed by flushing.

SIDE CONTROL KNOB STYLE:

There are 4 functions of the side control knob:

- DRYER/FLUSH • REAR WASH • LADY WASH • STOP

When the toilet is NOT occupied:

- Press the "Dryer/Flush" icon to flushing.
- Press and hold the "Stop" icon for 3 seconds to power on/off the toilet.

When the toilet is occupied:

- Press the "Dryer/Flush" icon, the toilet will start to activate the dryer followed by flushing.
- Press the "Dryer/Flush" icon to stop the Cleansing Features or dryer.

INSTRUCTION MANUAL

REMOTE CONTROL

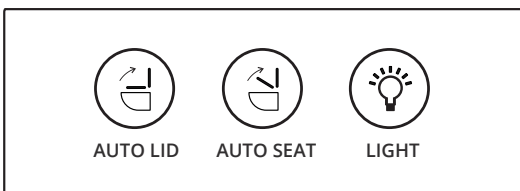
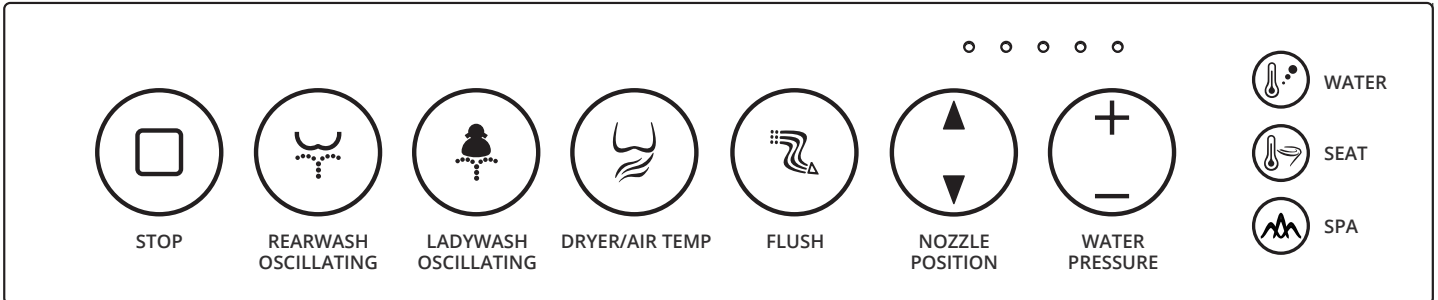







The remote control cannot be paired to the toilet while the toilet is occupied. For proper operation, follow the steps by different style below to confirm that the remote control and toilet are pairing.

- Side Control Panel Style: Press and hold "REAR WASH" icon on the left side of the toilet for 3 seconds, a short beep indicates that pairing status is activated. Press any icon on the remote control to finish pairing.

- Side Control knob Style: Turn and hold the control knob to the rear wash side for 3 seconds, a short beep indicates that pairing status is activated. Press any icon on the remote control to finish pairing.







REMOTE CONTROL DESCRIPTION

To activate features using the remote control, the remote must be paired with the toilet

ICON	DESCRIPTION
 STOP	Press "STOP" button to terminate the function of "rear wash"/"lady wash"/"dryer".
 REARWASH OSCILLATING	Turn the knob to "REAR WASH" mode, or press "REAR WASH" icon on the remote control, water spray from the rear outlet of the wand will be activated. Press again to enter the state of "OSCILLATING", which the washing area was expanded and the water moving forward and backward. Washing will stop automatically after 2 minutes.
 LADYWASH OSCILLATING	Turn the knob to "LADY WASH" mode, or press "LADY WASH" icon on the remote control, water spray from the front outlet of the wand will be activated. Press again to enter the state of "OSCILLATING", which the washing area was expanded and the water moving forward and backward. Washing will stop automatically after 2mins.
 WATER PRESSURE	ADJUSTING WATER PRESSURE Press the "+" or "-" icon to increase or decrease water pressure.
 NOZZLE POSITION	ADJUSTING NOZZLE POSITION Press the "▲" or "▼" icon to adjust the wand position through 3 settings.
 SPA	HOT AND COLD WATER MASSAGE Press "SPA" icon shortly during cleansing feature to active massage which hot and cold water washing alternately. Press the "STOP" icon to terminate all feature. PULSATE MASSAGE Press and hold "SPA" icon for 3 seconds during cleansing feature to active pulsate massage which water pressure changed alternately. Press the "STOP" icon to terminate all feature.

INSTRUCTION MANUAL

REMOTE CONTROL DESCRIPTION

ICON	DESCRIPTION
 DRYER/AIR TEMP	<p>Warm air dryer should be used after cleansing. Press and hold the knob for 3 seconds or press the " DRYER " icon to activate warm air dryer. This feature will stop automatically after 3 minutes.</p> <p>WARM AIR TEMPERATURE Press the " DRYER " icon to adjust the temperature of warm air dryer. Press the first time to show current warm air temperature. Press again to change warm air temperature into the suitable level.</p>
 FLUSH	<p>Press the " FLUSH " icon to manually flush the toilet. Double press the button quickly to activate small quantity water flush.</p> <p>AUTOMATIC FLUSH AFTER LEAVE When enabled (user seated at least 10 seconds), the toilet will automatically flush after the user stands up.</p>
 LIGHT	<p>NIGHT LIGHT Press the " LIGHT " icon on the remote control to open or close the nightlight.</p>
 WATER	<p>WATER TEMPERATURE Press the " WATER " icon to adjust cleansing water temperature. Press the first time to show current water temperature. Press again to change the water temperature into suitable level.</p>
 SEAT	<p>SEAT TEMPERATURE Press the " SEAT " icon to adjust cleansing water temperature. Press the first time to show current water temperature. Press again to change the water temperature into suitable level.</p>
 AUTO LID	<p>AUTO OPEN/CLOSE LID Press the "AUTO LID " icon on the remote control to open/close lid.</p>
 AUTO SEAT	<p>AUTO OPEN/CLOSE SEAT Press the " AUTO SEAT " icon on the remote control to open/close seat.</p>

Press " **WATER** " repeatedly, the corresponding gear will be activated.

Press " **DRYER** " repeatedly, the corresponding gear will be activated.

Press " **SEAT** " repeatedly, the corresponding gear will be activated.

The temperature of warm air will be changed to suitable temperature automatically subjects to the environment temperature.

After press the icon, a short beep indicates that the feature is enabled, and no beep indicates that the feature is disabled. When the toilet is power-off and restart, all setting above will be saved as the situation before the power-off.

The remote control cannot be paired to the toilet while the toilet is occupied. For proper operation, follow the steps by different style below to confirm that the remote control and toilet are pairing.

• Side Control Panel Style: Press and hold " REAR WASH " icon on the left side of the toilet for 3 seconds, a short beep indicates that pairing status is activated. Press any icon on the remote control to finish pairing.

• Side Control knob Style: Turn and hold the control knob to the rear wash side for 3 seconds, a short beep indicates that pairing status is activated. Press any icon on the remote control to finish pairing.

To activate features using the remote control, the remote must be paired with the toilet

INSTRUCTION MANUAL

INSTALLATION INSTRUCTION

REQUIRED TOOLS

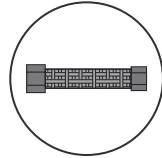

3/8 TO 3/4
STAINLESS STEEL
BRAIDED HOSE



MEASUREMENT
TAPE



WRENCH



SCREWDRIVER

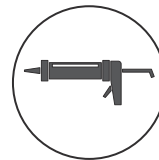

SILICONE GUN

01

1. Turn on the valve and flush for 1 minute, to flush out any sundries/debris that may damage the toilet structure.
2. Screw the adapter onto the braided hose (not provided), ensuring that the direction of the adapter arrow is as shown in the figure.
3. For the joint assembly, you should tighten the threaded joint 1-2 turns beyond finger tight, be careful not over tighten

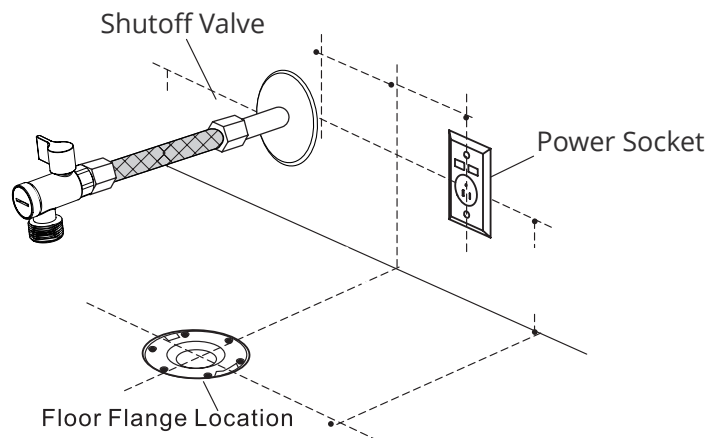
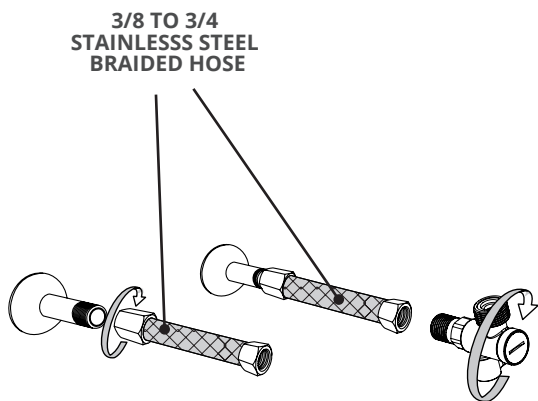

INSTRUCTION MANUAL

02 CONFIRM WATER FLOW

1. Install a matching hose, which is guided to a bucket of 3 gallons (11 .4L) or more.
If you cannot find a matching hose, you can use a cloth to cover the outlet of the supply stop and place the bucket under the valve
2. Turn on the supply stop. Ensure that the water can outflow at least 1 gallon within 10 seconds
3. Close the supply stop
4. Remove the installed hose

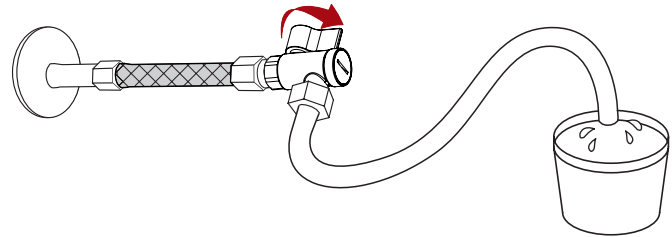

- ### 03
- For new installations, toilet flanges need to be installed. Install flange bolts.

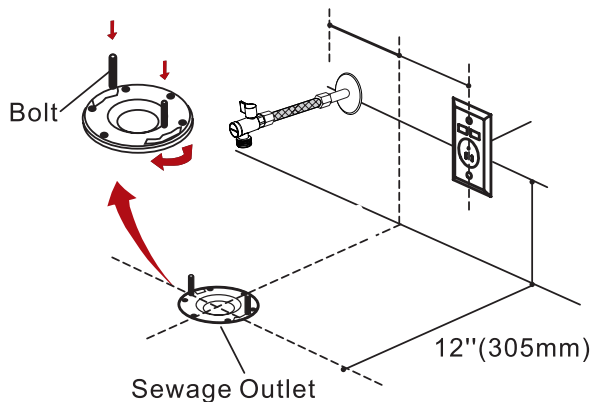

- ### 04
- Install a sealing ring under the toilet.

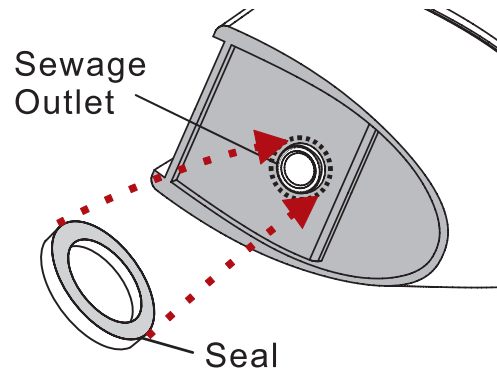

- ### 05
- Install the toilet to the flange and ensure that the bolts are aligned with the holes in the toilet. Use a wrench to lock nuts and other accessories to the fixing bolts.

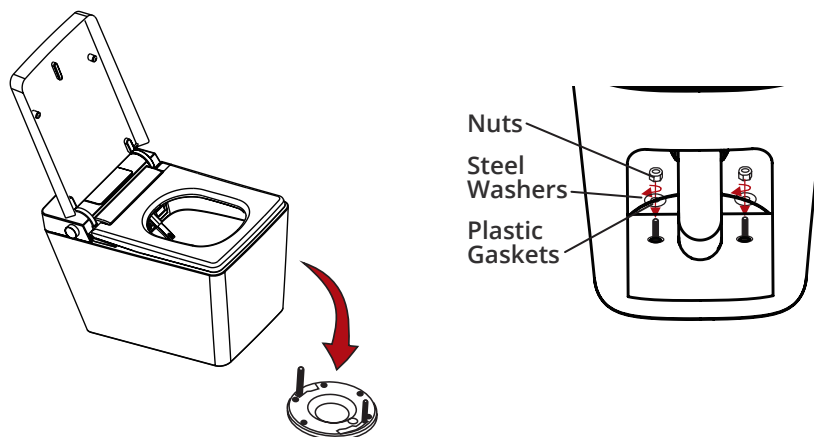

09

Connect the water inlet hose to the supply stop.

NOTE:

1. After tightening by hand, turn the nut with a wrench.
2. Open the Supply Spot.
3. Check for leaks.
4. Apply Silicone to the bottom of the toilet.
Wait 24 Hrs. to dry.

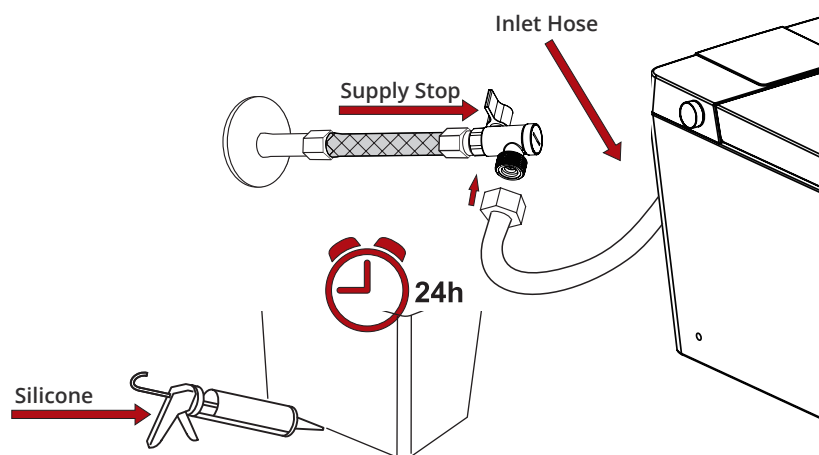

MAINTENANCE

SURFACE CLEANING

⚠ Please make sure the electrical plug is taken out ⚠

Use a smooth sponge/cloth with diluted kitchen detergent (soapy water) to clean the product. The following things are forbidden to use for surface cleaning: hydrogen chloride detergent, painting thinner, benzene, abrasive paper, polishing agent, fragrance and insecticide, etc.

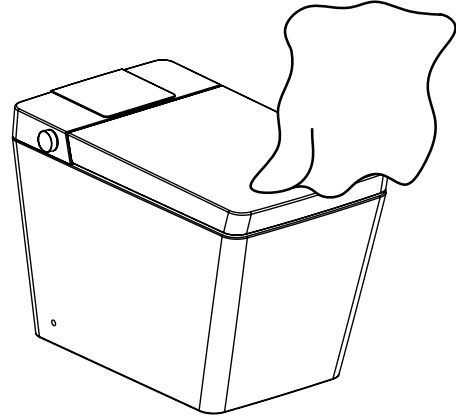

NOZZLE CLEANING

⚠ Attention: Do not use steel brush to clean ⚠

When the product is standby, press and hold the female wash button for 3 seconds until the beeps to activate cleaning wand coming out. Then use a toothbrush to clean the nozzle.

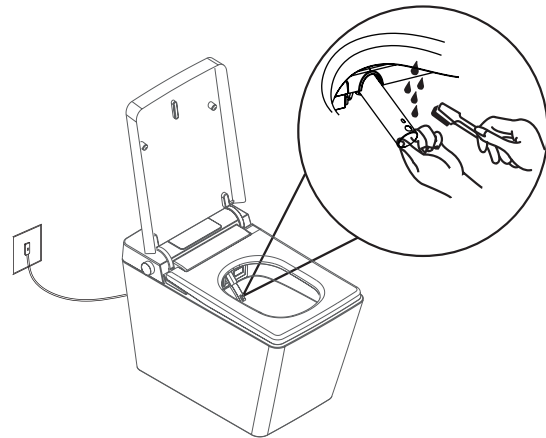

FILTER CLEANING

1. Close the valve and stop the water supply

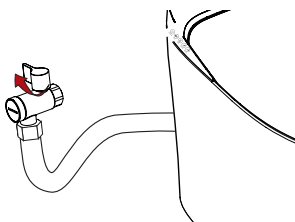

⚠ Attention: Do not remove the filter without closing the angle valve. Otherwise water will spray out.

2. Remove the filter. Unscrew the cover of the filter with a screwdriver and pull it out as shown

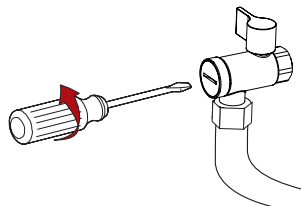

3. Clean the filter. Get the filter out and clean it thoroughly. Flush off dirt or clean the filter with a toothbrush

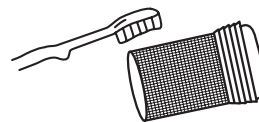

⚠ Attention: Do not use any cleaning agents. Clean it with water only. Do not crush the filter when cleaning.

4. Reattach the filter.

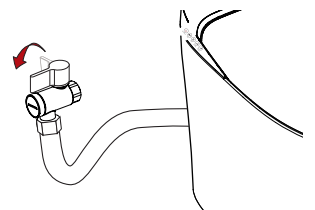

⚠ Attention: Open the valve and make sure there is no water leakage.

TROUBLESHOOTING

ISSUES	CAUSE	SOLUTION
NO POWER	The electrical outlet is not connected to power supply or the plug is not inserted to the bottom	Check if the electrical outlet is connected to the power supply; press the reset key on the plug
NO WATER COMES OUT WHILE CLEANING	Low pressure of water supply	Raise the water pressure
	Water inlet filter blocked	Remount and clean the filter according to the instruction
CLEANSING WATER IS NOT WARM ENOUGH	Water temp setting is incorrect	Readjust
SEAT DOES NOT HEAT	Seat temp setting is incorrect or the toilet is in power saving mode	Readjust
SEAT AND COVER ARE LOOSE	Fixed bolts are loose	Tighten the bolts
REMOTE CONTROLLER FAILURE	Battery ran out	Replace battery
NO RESPONSE WHEN PRESSING THE KEY	Key fault	Reboot
WATER LEAKAGE	Shutoff valve, check water supply hose and water separator they might not be well connected	Reconnect/connet properly

Valley Bidets are warranted for residential use for a period of 1 year from the original purchase date, against any failure from improper manufacturing defects.