

CONFIGURATION

The VARHSK06 comes with the following products:

- **802.752.100**
4" Round shower head
- **120A.011.100**
Hand Shower Rail
- **802.503.100**
Supply Elbow
- **000.697.000**
Universal Rough-in
- **T802.697.100**
Round Trim Kit

FINISH



Chrome

CERTIFICATIONS

CSA B125.1-11
ASME A112.18.1-2011

WARRANTY

Residential: These products have a limited 1 year warranty period, with the exception of the cartridges which have a limited lifetime warranty period of ten (10) years for multi-family residential applications from the original purchase date against any failure from improper manufacturing defects.

Commercial: These products have a limited 1 year warranty period, with the exception of the cartridges which have a limited lifetime warranty period of five (5) years from the original purchase date against any failure from improper manufacturing defects. (If you can present your proof of purchase, we will provide the replacement cartridge at no charge to you.)

802.752.100
SHOWER HEAD



120A.011.100
HAND SHOWER RAIL



T802.697.100
ROUND TRIM KIT





802.752.100
4" ROUND SHOWER HEAD

- Adjustable 4" Rain shower head
- Shower arm & flange
- Brass body
- Chrome finish.
- Complies with CSA & IAPMO standards

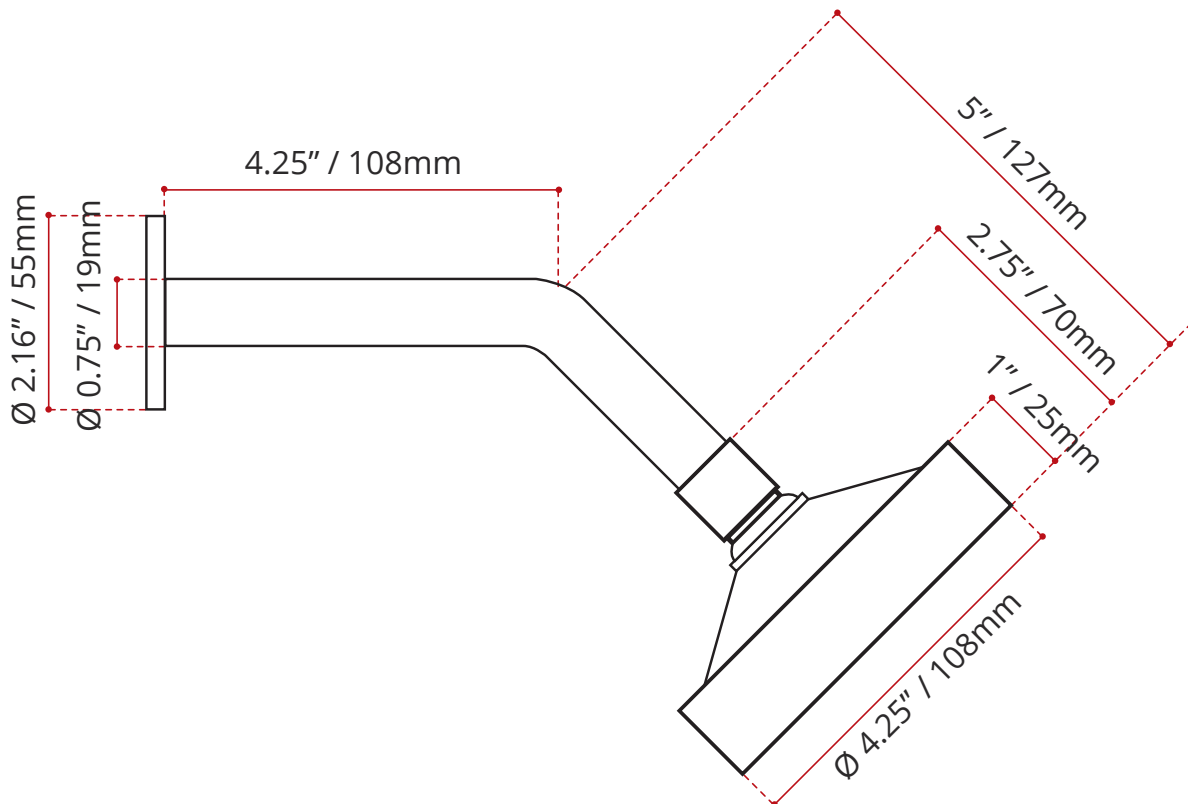

DISCLAIMER: Measurements may vary $\pm \frac{1}{4}$ " (Diagram Not to scale)



120A.011.100
HAND SHOWER RAIL

- Chrome finish
- 61.5" reinforced PVC hose
- Round Hand Shower
- Solid brass body
- 23.8" Slide bar
- Corrosion & discolouration resistant
- Complies with CSA & IAPMO standards

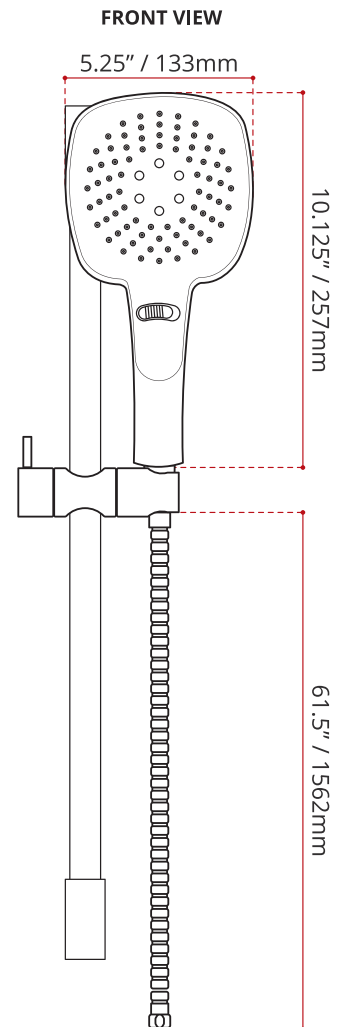
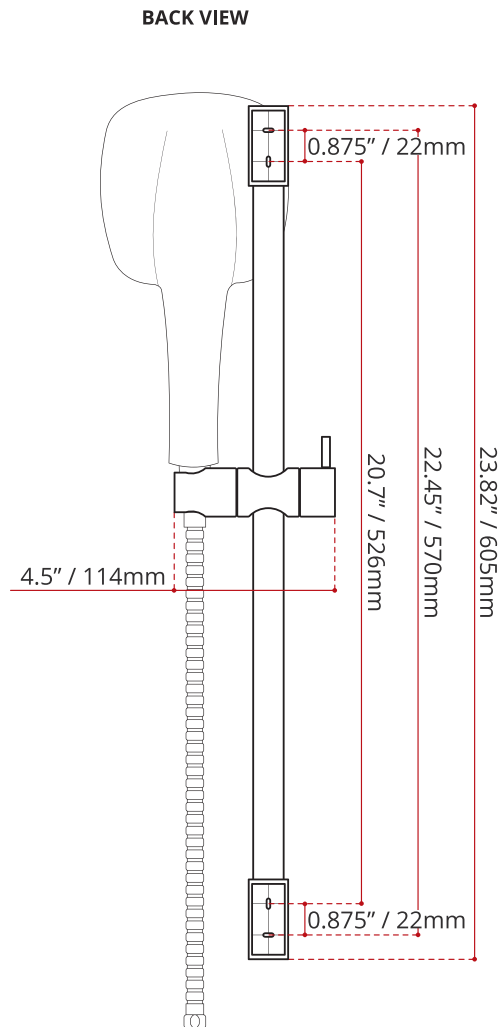
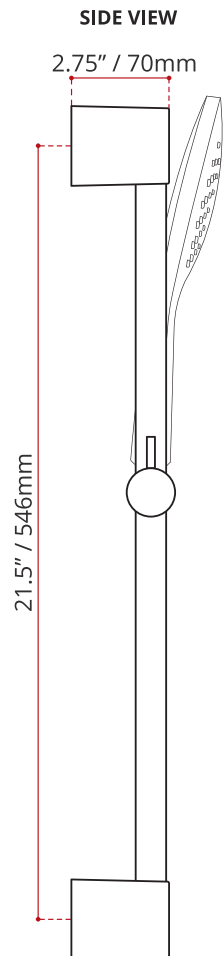



802.503.100
HAND SHOWER RAIL

- Removable plate.
- G 1/2" NPT Female thread.
- G 1/2" NPT Male thread.
- Chrome finish.

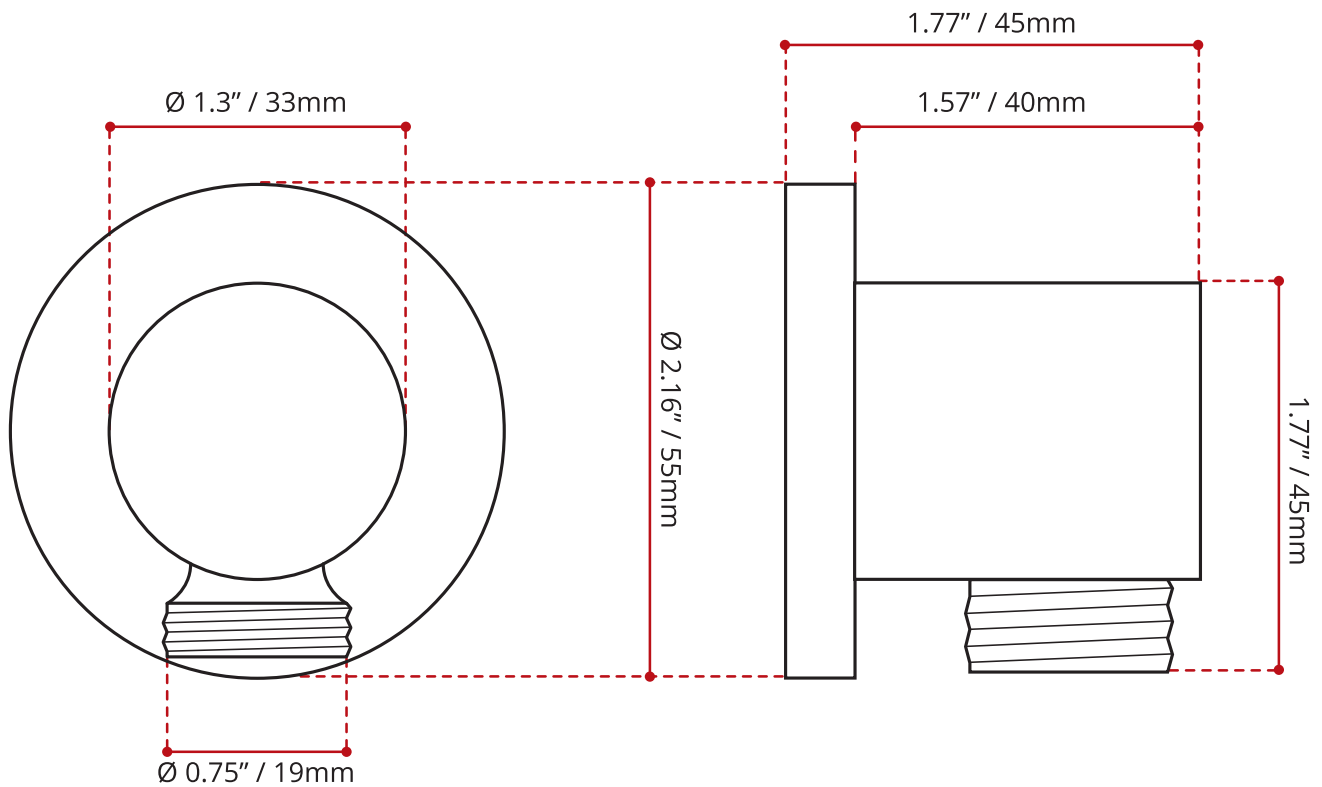



000.697.000
UNIVERSAL ROUGH-IN

- Solid brass construction
- Back-to-Back installation capabilities
- Square plasterguard allows for right angle cuts
- Thin wall mounting
- Test cap included
- Complies with CSA standards

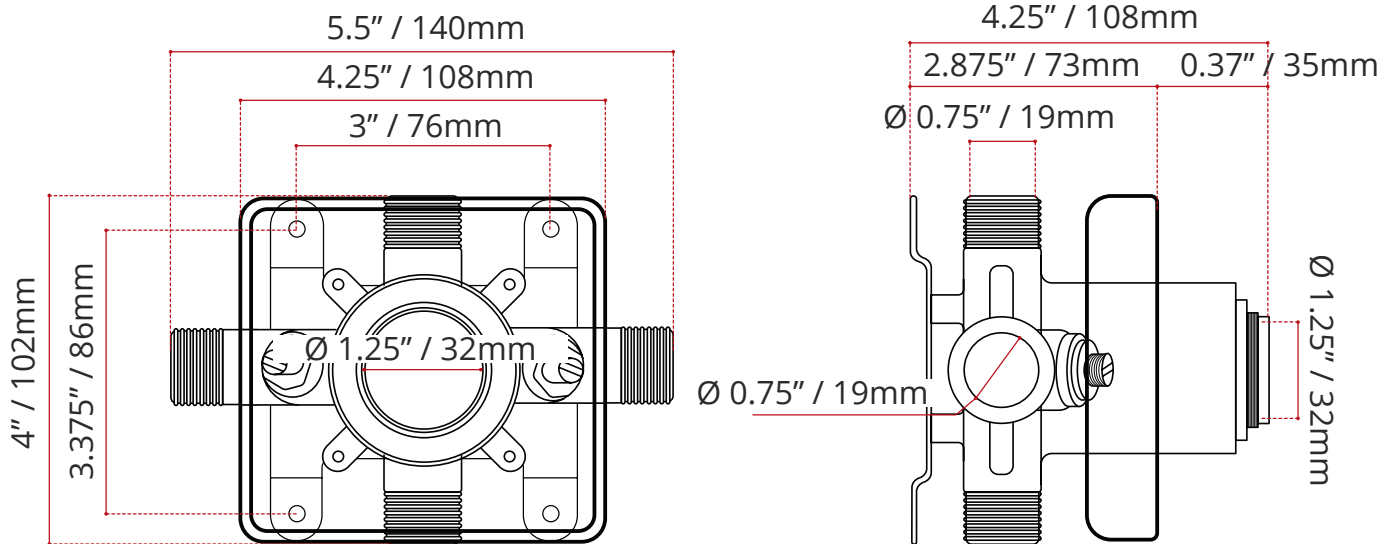

DISCLAIMER: Measurements may vary $\pm \frac{1}{4}$ " (Diagram Not to scale)



T802.697.100
ROUND TRIM KIT

- Single Handle Round trim kit
- For use with 000.697.000 Universal rough-in
- High quality, drip-free ceramic cartridge
- Corrosion & discolouration resistant
- Complies with CSA & IAPMO standards

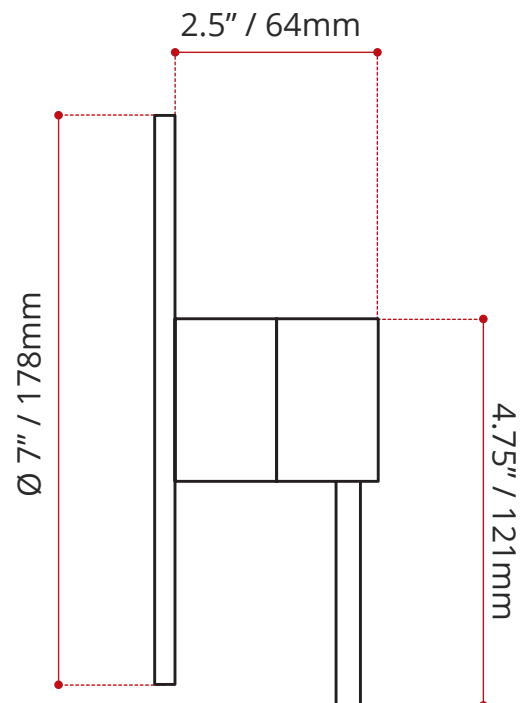
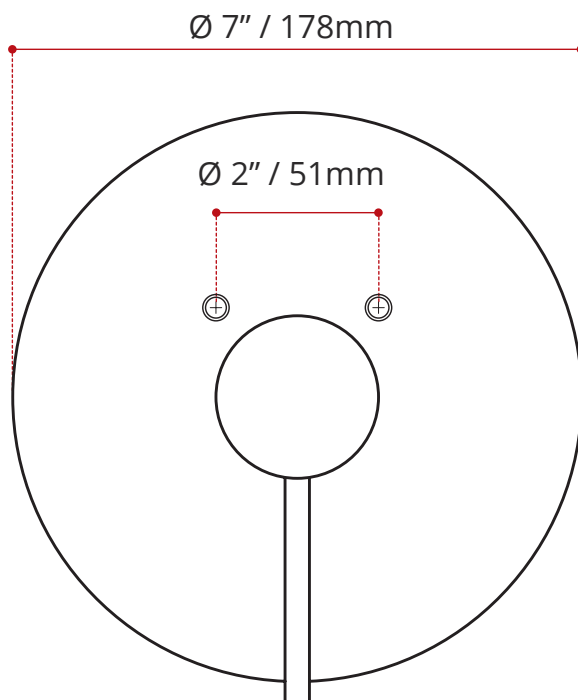

DISCLAIMER: Measurements may vary $\pm \frac{1}{4}$ " (Diagram Not to scale)